



Instructions by Monster Shop (UK)

Water Feature – Serenity Falls

Water Features bring a serene, cascading water display to your garden or patio. Its design creates a calming flow of water perfect for enhancing the tranquil atmosphere of any outdoor space, ideal for adding a touch of elegance and relaxation to your surroundings



Safe Working Practice

- Ensure the product is installed on a flat, stable surface to prevent tipping or imbalance, especially when filled with water. Uneven ground can lead to instability and potential accidents.
- Follow the assembly instructions carefully. Improper assembly can cause leaks, instability, or structural failure, which may lead to injury or damage.
- If the water feature is made from polyresin, avoid exposing it to direct sunlight for extended periods as UV light may cause material degradation or discolouration over time. For cement models, avoid harsh impacts, as cement can crack or chip.
- Always use the recommended type of water pump. Using an incompatible or incorrect pump could lead to electrical hazards, mechanical failure, or damage to the water feature.
- Ensure that the water pump and any electrical components meet safety standards, are suitable for outdoor use, and are rated for the local voltage requirements (e.g., 220–240V in the UK). Improper electrical connections can cause fire, shock, or serious injury.
- Place the water feature near a ground-fault circuit interrupter (GFCI) outlet for electrical safety, and regularly test the GFCI to ensure it is functioning properly.
- Ensure that all electrical cords are routed away from walkways and are properly secured to avoid tripping hazards. Do not allow electrical components to sit in water or become submerged unless specified as waterproof.
- Avoid overfilling the water feature to prevent splashing or water damage to surrounding areas. Follow the recommended water level in the product manual to avoid pump damage or malfunction.
- Regularly inspect the water feature for any cracks, chips, or damage. Repair or replace any damaged components immediately to avoid further damage or injury.
- Keep the water clean by following regular maintenance and water treatment guidelines. Dirty water can lead to blockages or pump failure.
- Turn off the pump and disconnect any electrical components before performing maintenance or cleaning to avoid the risk of electric shock or injury.
- Do not allow children or pets to climb or play near the water feature to prevent accidents such as falling or drowning, especially for larger models that hold more water.
- The product should be used strictly as a decorative water feature. Do not use it for bathing or any other unintended purpose, as this could damage the product or lead to injury.
- In case of freezing weather, drain the water and store the product indoors if possible. Freezing water can expand and cause cracks or other damage to both polyresin and cement models.



- The water feature may be heavy, especially if made of cement. Ensure it is moved and lifted properly by multiple people if necessary to avoid injury. Do not attempt to move the product when filled with water.
- If the water feature contains lighting elements, ensure all bulbs are correctly rated for outdoor use and replace them only with parts rated for safe outdoor use to avoid electrical hazards.
- Do not use harsh chemicals, abrasive cleaners, or pressure washers on polyresin or cement surfaces as this could lead to material degradation or discolouration.
- Check the water pump regularly to ensure it is functioning correctly, and clean it as instructed to prevent blockages or malfunctions, which could lead to overheating or electrical issues.

Product Specifications

- **SKU:** 214277
- **Dimensions:** 40x40x101 cm
- **Weight:** 14.8kg
- **Material:** Cement
- **Cable length:** 7m

Parts

Fountain
1 piece(s)

Pump
1 piece(s)

Reservoir
1 piece(s)

Cleaning Brush
1 piece(s)

Steps (8)

Step 1 of 8

Place the base on a flat surface, then insert the reservoir.



Step 2 of 8

Insert the water pump into water tube.

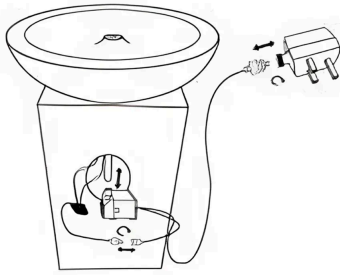

Step 3 of 8

Insert the fountain top on reservoir.



Step 4 of 8

Add water so that the pump is submersed in the water.



Step 5 of 8

Make sure the water tube is connected to the pump and not bent.



Step 6 of 8

The concave edge of the fountain should adhere to the convex part of the reservoir. Make sure the electric wire can pass through the wire opening.

Step 7 of 8



Connect the power cable to the outlet. If installed correctly water should flow from the fountain. On first use the potentially could have air in the pump so, it makes take a few minutes until the air escapes.

8. Maintenance

- Make sure you clean it regularly and remove any blockages or dirt that may have built up.
- If the pump starts to lose power or stops working, check the bottom of the pump housing and the reservoir for any buildup of sediment or scale.
- Maintain water levels to always ensure pump is submerged. Change the water often.
- If not in use for an extended period, drain the reservoir and store in a dry sheltered location.

Terms of Service: <https://monstershop.co.uk/policies/terms-of-service>

