

A StepAlong by Monster Shop (UK)

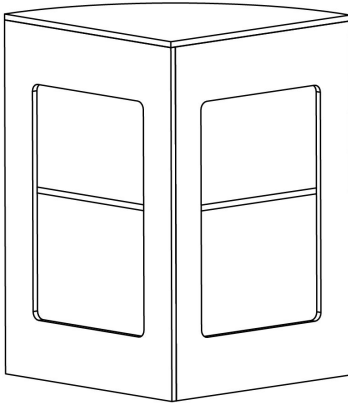

CM60 Shop Counter

214585, 214586, 214587

Unit Overview

The curved corner shop counter works just as well as a standalone unit as it does as part of a team as an extension to other counters. To properly round off its appeal, it also has an expensive-looking laminate finish. Why not try it as a point of sale shop counter or alongside other counters to make a customer service area? Let customers be almost as impressed with its design appeal as they are with your stock. You can also secretly store handy items on its shelves that you need access to in a hurry, like till roll or carrier bags. Whether you decide to use this corner shop counter as the point of sale or as a beautiful retail display unit, it will give your stock and establishment that little extra touch of class and professionalism. Available in maple or white lilac.

Dimensions

Width: 600mm

Height: 900mm

Depth: 600mm



Safety Advice

- Make sure the unit is positioned on a flat, stable surface to prevent wobbling or tipping.
- If placing the unit on uneven flooring, use appropriate levelling methods to secure the unit.
- Do not exceed the specified weight limits for the shelves and surfaces to avoid damage to the unit or risk of injury.
- Ensure products are evenly distributed across shelves to prevent tipping or overloading.
- Ensure that children do not climb or play on the unit to prevent accidents or injury.
- Regularly inspect for any wear, such as loose screws or weak joints, and tighten or repair as necessary.
- Be cautious when handling items on glass shelves. Do not overload the shelves beyond their stated capacity, as this could lead to cracking or shattering.
- There may be debris and/or sawdust in the pre-drilled holes. Remove this before commencing with assembly. Use gloves to remove it.

Parts

Part 1 - Counter Top

1 Piece(s)



Part 3 - Bottom Shelf

1 Piece(s)



Part 5 - Side Panel

1 Piece(s)



Part 7 - Base

1 Piece(s)



Part B - CAM Lock

15 Piece(s)

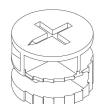

Part 2 - Middle Shelf

1 Piece(s)



Part 4 - Side Panel

1 Piece(s)



Part 6 - Back Panel

1 Piece(s)



Part A - Screw

15 Piece(s)



Steps (11)

1.

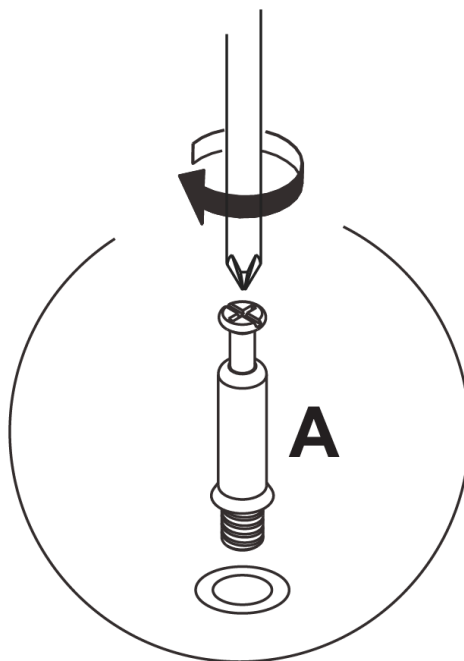
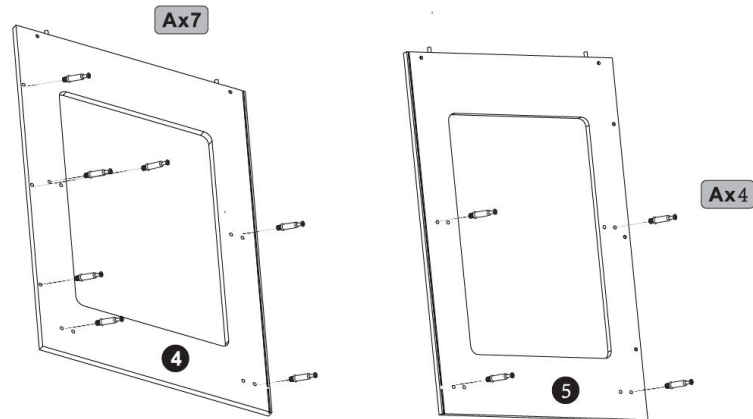

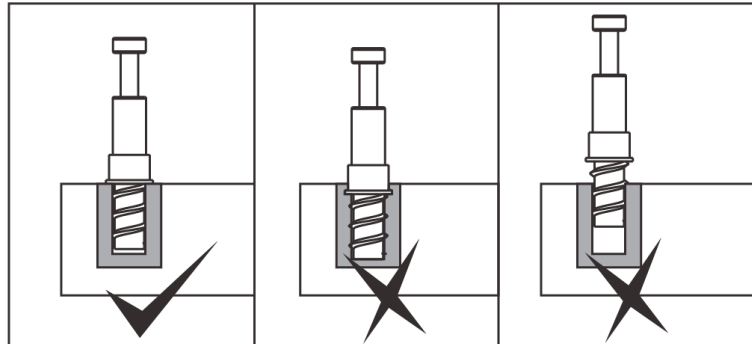

2.

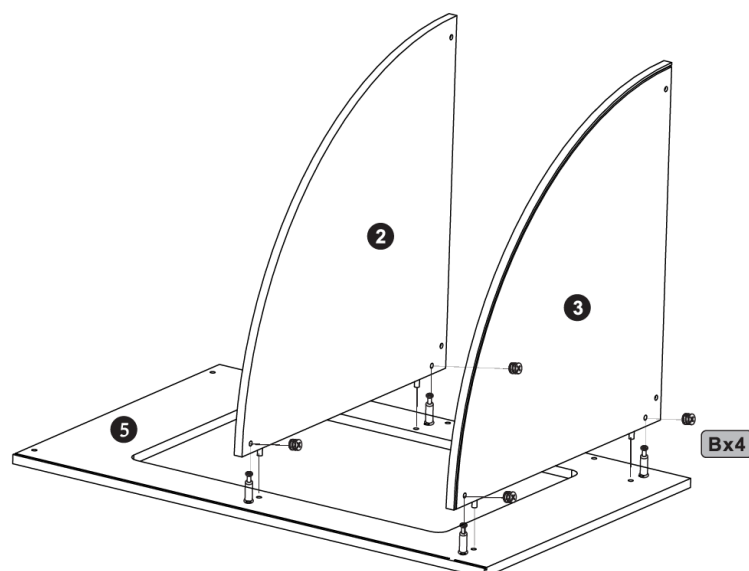

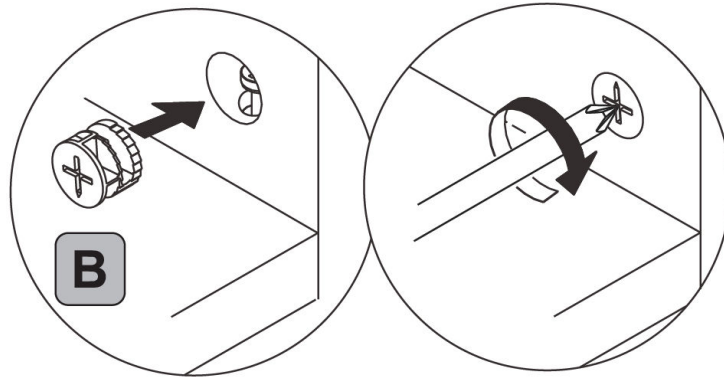

3.

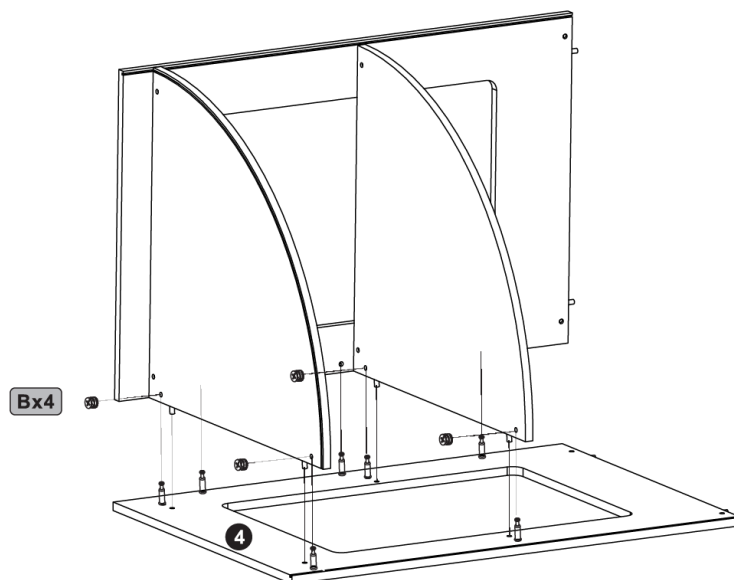

4.

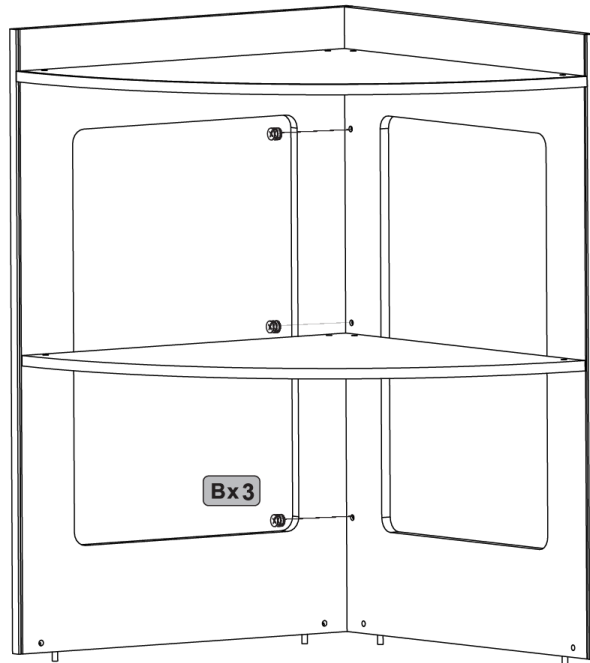

5.

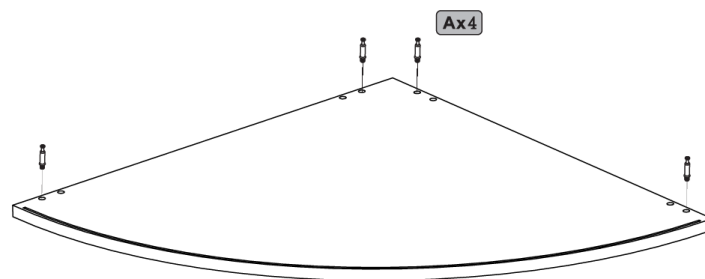

6.

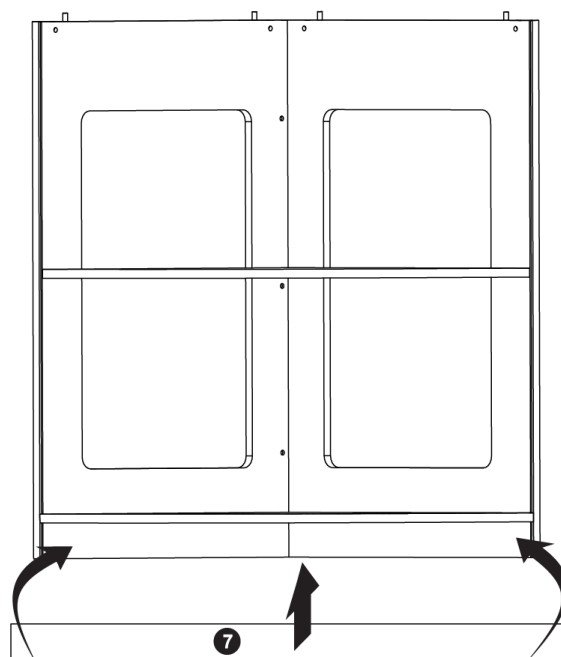

7.

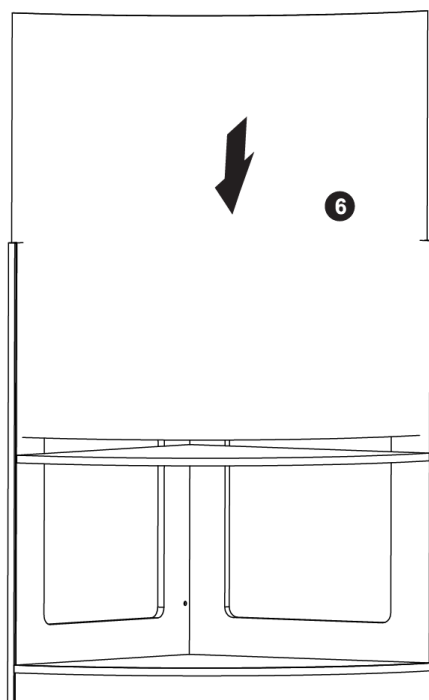

8.

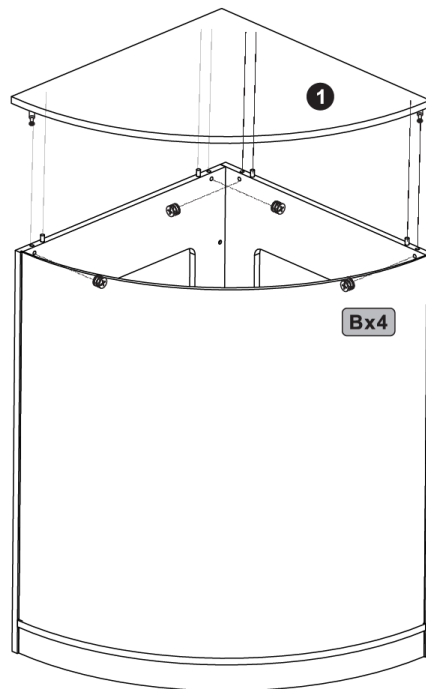

9.

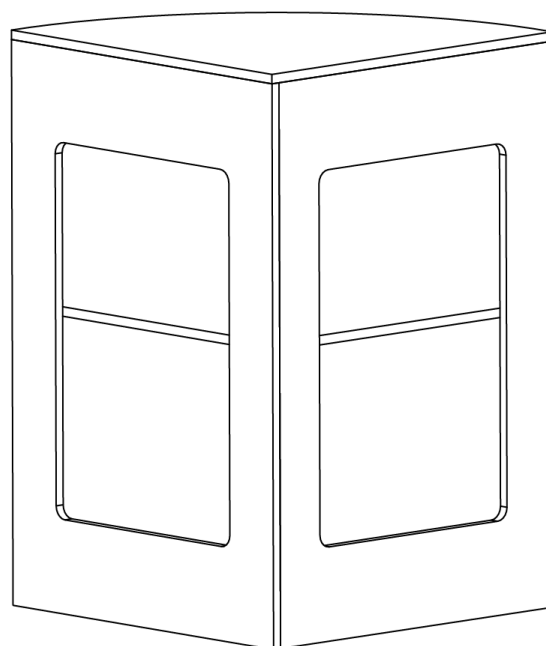

10. Maintenance

- Clean the unit with a soft, damp cloth. Avoid using harsh chemicals or abrasive cleaners, which could damage the laminate or glass surfaces.

11. Troubleshooting

• **WHAT DO I DO IF THERE ARE MISSING PARTS FROM MY ORDER?**

If there appears to be any part missing from your order, contact our friendly and helpful Customer Support Team within 7 days of receipt.

- **FOR ALL OTHER ISSUES, PLEASE CONTACT OUR CUSTOMER SUPPORT TEAM.**



A StepAlong by Monstershop

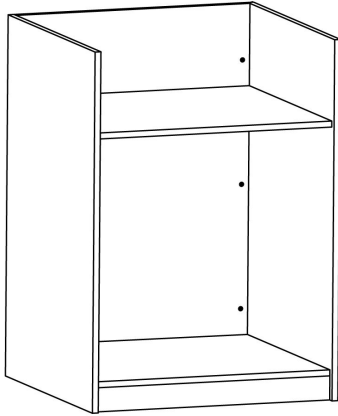

TB60 Shop Counter

204102, 204103, 214588

Unit Overview

Elevate your point of sale with the sleek and functional TB60 till block. Designed with a recessed top shelf, this unit provides the perfect space for your cash register and card machine, ensuring easy access and an ergonomic setup for smooth customer transactions. Beneath the till, a spacious storage area offers plenty of room to discreetly stow essential items such as plastic bags, till rolls, gift wrap, or even a small bin to keep your workspace neat and organised.

Built to handle the weight of even the heaviest payment systems, the TB60 combines sturdy construction with a stylish laminate finish in maple, black, or white. Its clean, professional design seamlessly fits into any retail environment, helping staff present a polished and organised appearance while working behind the counter.

Dimensions

TB60 Dimensions:

- **Product Height:** 0.9m
- **Product Depth:** 0.6m
- **Product Width:** 0.6m
- **Storage Area Dimensions:** 56.4cm wide x 63.2cm high
- **Till Area Dimensions:** 56.4cm wide x 17.3cm high
- **Product Net Weight:** 30.1KG



- **2 Colours:** Black, White

Safety Advice

- Make sure the unit is positioned on a flat, stable surface to prevent wobbling or tipping.
- If placing the unit on uneven flooring, use appropriate levelling methods to secure the unit.
- Do not exceed the specified weight limits for the shelves and surfaces to avoid damage to the unit or risk of injury.
- Ensure products are evenly distributed across shelves to prevent tipping or overloading.
- Ensure that children do not climb or play on the unit to prevent accidents or injury.
- Regularly inspect for any wear, such as loose screws or weak joints, and tighten or repair as necessary.
- Be cautious when handling items on glass shelves. Do not overload the shelves beyond their stated capacity, as this could lead to cracking or shattering.
- There may be debris and/or sawdust in the pre-drilled holes. Remove this before commencing with assembly. Use gloves to remove it.

Parts

A – Front Panel

1 Piece(s)



C – Kick Plate

1 Piece(s)



E – Side Panel

1 Piece(s)



B – Shelf Panels

2 Piece(s)



D – Side Panel

1 Piece(s)



1 – Connector Screw

14 Piece(s)



2 - Cam Lock

14 Piece(s)



Steps (6)

1.

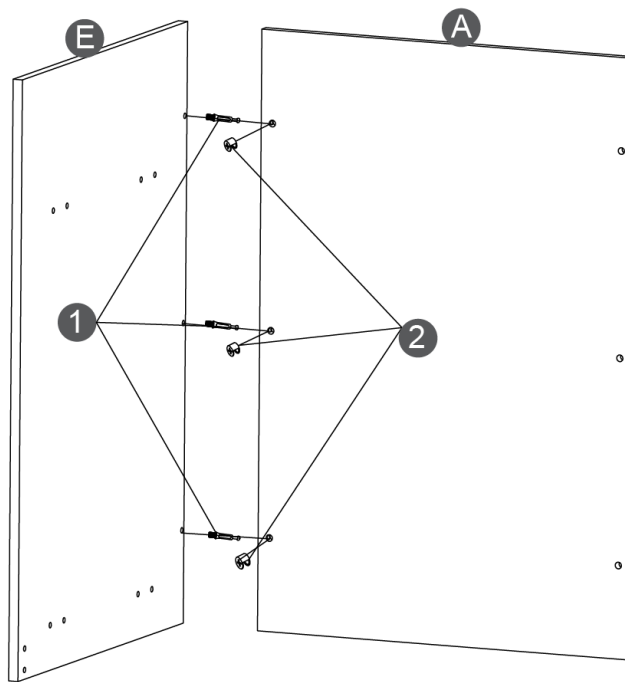

2.

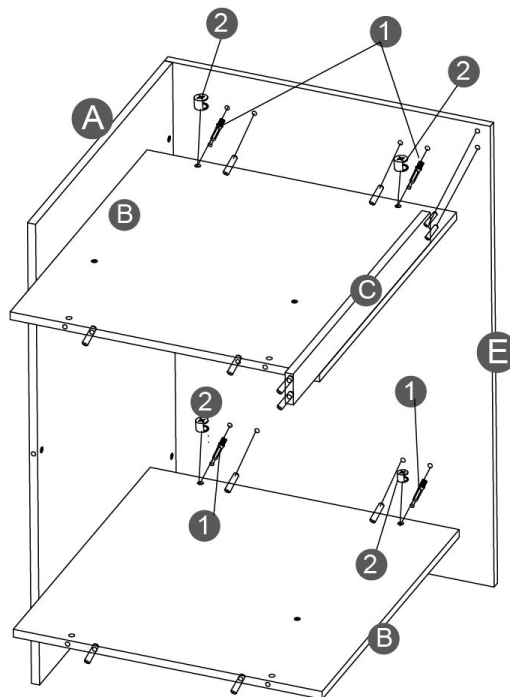

3.

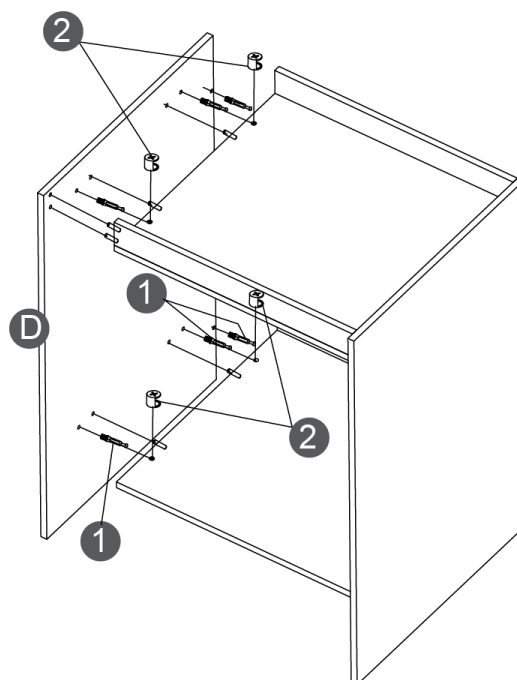

4.

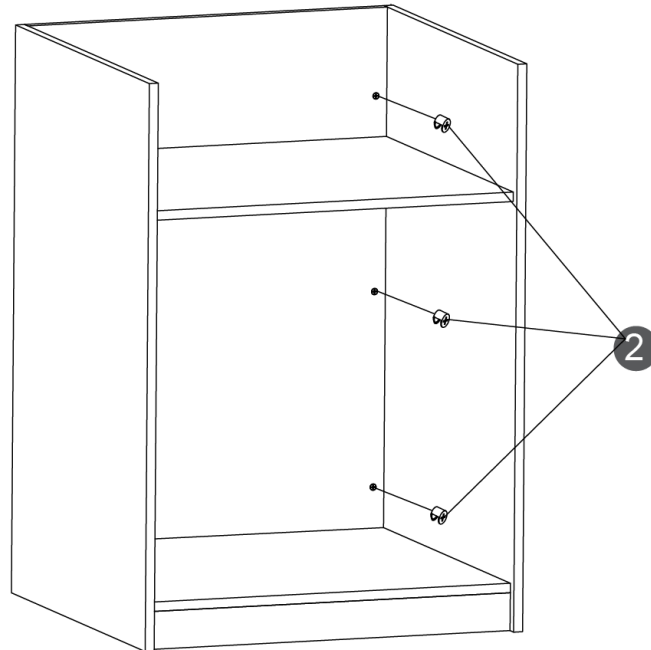

5. Maintenance

- Clean the unit with a soft, damp cloth. Avoid using harsh chemicals or abrasive cleaners, which could damage the laminate or glass surfaces.

6. Troubleshooting

- **WHAT DO I DO IF THERE ARE MISSING PARTS FROM MY ORDER?**

If there appears to be any part missing from your order, contact our friendly and helpful Customer Support Team within 7 days of receipt.

- **FOR ALL OTHER ISSUES, PLEASE CONTACT OUR CUSTOMER SUPPORT TEAM.**



A StepAlong by Monstershop

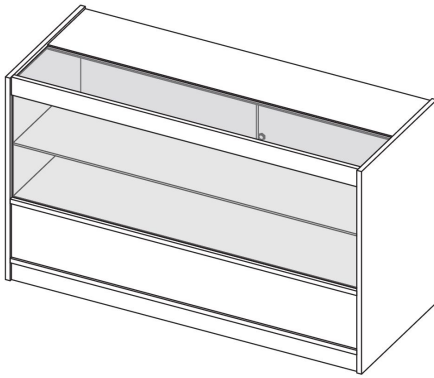

C900-1200 LED Shop Counter

204107/204108/204109/204116/204117/204118

Unit Overview

The C retail counter is a versatile unit that offers both extensive display options and secure storage. The top section includes two glass-fronted shelves, complete with LED lighting to create an attractive, illuminated display for products. Beneath the display area, hidden storage provides ample space for supplies or stock, secured by lockable doors for added protection. With its durable laminate finish, this counter ensures long-lasting durability and easy maintenance. Available in black, white, and maple, it's the perfect solution for retailers looking to balance elegant product presentation with functional storage.

Dimensions

C900 Dimensions:

- **Product Height:** 0.9m
- **Product Depth:** 0.6m
- **Product Width:** 0.9m
- **Top Shelf Max Storage Height:** 21.5cm
- **Middle Shelf Max Storage Height:** 21.8cm
- **Bottom Shelf Max Storage Height:** 30.5cm
- **Product Net Weight:** 64.5kg
- **Keys Included:** 2
- **3 Colours:** Black Maple, White



C1200 Dimensions:

- **Product Height:** 0.9m
- **Product Depth:** 0.6m
- **Product Width:** 1.2m
- **Top Shelf Max Storage Height:** 21.5cm
- **Middle Shelf Max Storage Height:** 21.8cm
- **Bottom Shelf Max Storage Height:** 30.5cm
- **Product Net Weight:** 82.4kg
- **Keys Included:** 2
- **3 Colours:** Black, Maple, White

Specifications**C900 Specifications:**

- **Power (W):** 5.3W
- **Power Supply (Input Voltage):** 100~240V
- **Voltage:** 12V
- **Brightness (Lumen):** 221.1LM
- **Colour Temperature (K):** 6489K
- **Lifespan (Hours):** 30000H
- **Operating Temperature Range:** '-20 ~ 50

C1200 Specifications:

- **Power (W):** 7.2W
- **Power Supply (Input Voltage):** 100~240V
- **Voltage:** 12V
- **Brightness (Lumen):** 296.1LM
- **Colour Temperature (K):** 6432K
- **Lifespan (Hours):** 30000H
- **Operating Temperature Range:** '-20 ~ 50



Safety Advice

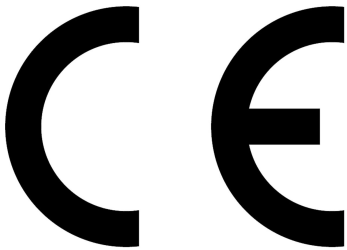

- Please read through the Safe Working Practice to ensure prevention of injury or damage to the device.
- Make sure the unit is positioned on a flat, stable surface to prevent wobbling or tipping.
- If placing the unit on uneven flooring, use appropriate levelling methods to secure the unit.
- Do not exceed the specified weight limits for the shelves and surfaces to avoid damage to the unit or risk of injury.
- Ensure products are evenly distributed across shelves to prevent tipping or overloading.
- Ensure that children do not climb or play on the unit to prevent accidents or injury.
- Regularly inspect for any wear, such as loose screws or weak joints, and tighten or repair as necessary.
- There may be debris and/or sawdust in the pre-drilled holes. Remove this before commencing with assembly. Use gloves to remove it.
- Be cautious when handling items on glass shelves. Do not overload the shelves beyond their stated capacity, as this could lead to cracking or shattering.



- Always ensure the unit is properly plugged into a suitable power outlet with the correct voltage as indicated in the specifications.
- Do not allow the LED light strip to come into contact with water or moisture to avoid electrical hazards.
- Regularly inspect the LED strip and power cables for wear or damage. If any damage is noticed, immediately disconnect the power supply and seek professional assistance for repairs.
- Never attempt to modify or alter the electrical components or wiring of the LED light system.
- Ensure the power supply is switched off before performing any maintenance, cleaning, or adjusting of the LED lights.
- We recommend turning off the LED lights at the close of each business day to ensure energy efficiency and prolong the lifespan of the lights.
- Ensure proper ventilation around the LED lights to avoid overheating, especially if the unit is in constant use.
- Avoid covering or obstructing the LED lights to prevent overheating, which could shorten their lifespan or cause damage.
- Do not install the unit near any heat sources, such as radiators, as excessive heat can affect the longevity of the LED strip.
- Keep power cables and exposed lighting out of reach of children and animals to avoid accidental damage or injury.



Parts

1 - Center Shelf

1 Piece(s)



3 - Lower Shelf

1 Piece(s)



5 - Kick Plate

1 Piece(s)



7 - Front Glass Panel

1 Piece(s)

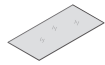

9 - Countertop Glass

1 Piece(s)

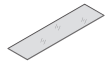

11 - Side Panel

1 Piece(s)



13 - Door with Lock Slot

1 Piece(s)



A - Connector Screw

14 Piece(s)



C - Door Lock

1 Piece(s)



E - Power Adapter

1 Piece(s)



G - Slot Cover Strip

3 Piece(s)



2 - Front Panel

1 Piece(s)



4 - Kick Plate with Cable
Pass-Through

1 Piece(s)



6 - Side Panel

1 Piece(s)

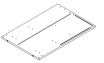

8 - Glass Mounting Bar

1 Piece(s)



10 - LED-Integrated Counter-
top

1 Piece(s)



12 - Glass Shelf

1 Piece(s)

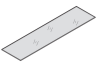

14 - Door

1 Piece(s)



B - Cam Lock

14 Piece(s)



D - Phillips Head Screw

4 Piece(s)



F - LED Extension Cable

1 Piece(s)



H - Glass Shelf Support

4 Piece(s)



Steps (25)

1.

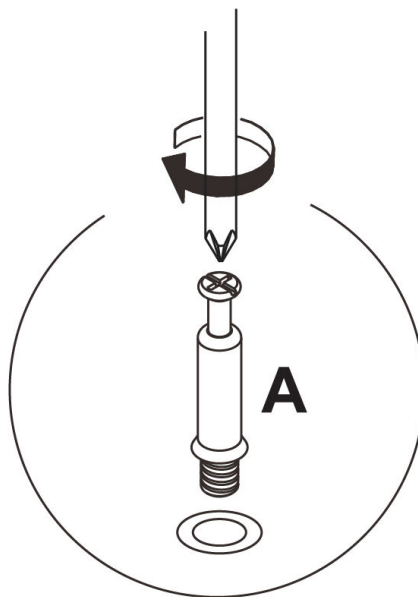
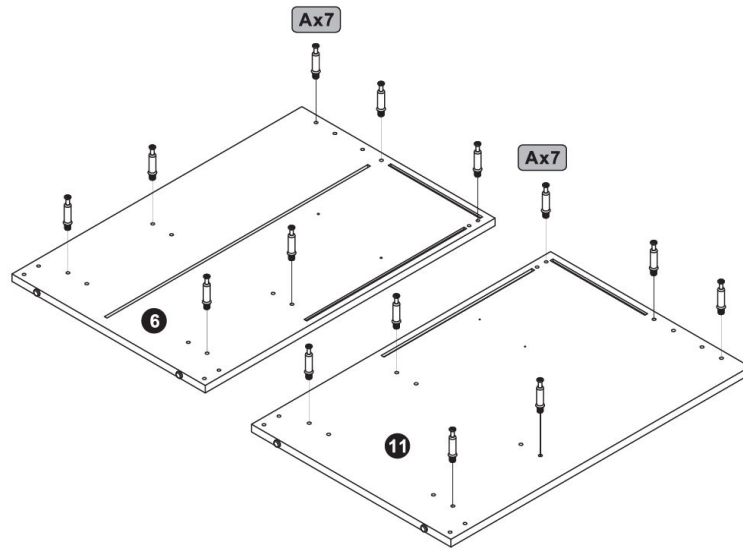

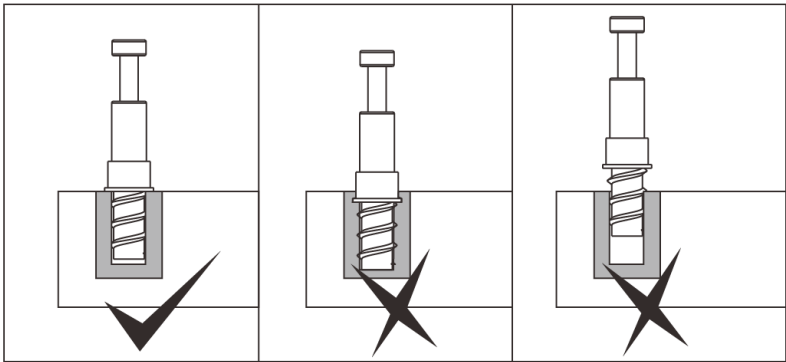

2.

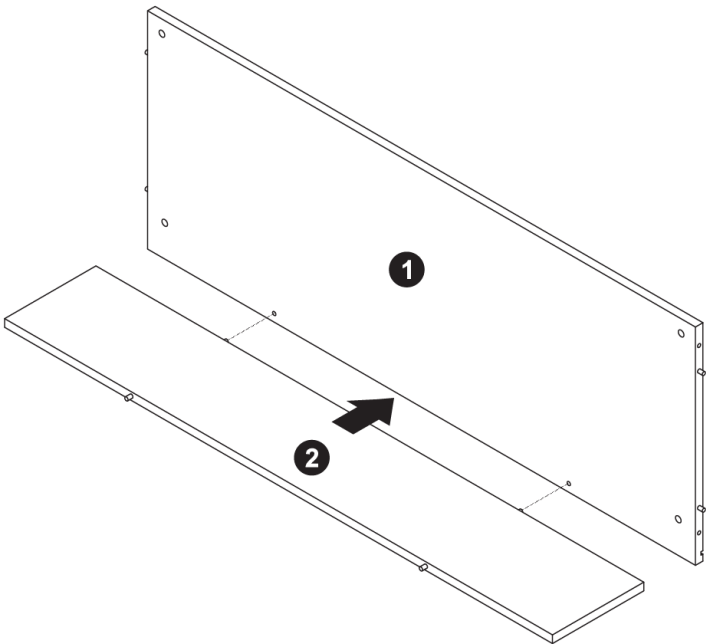

3.

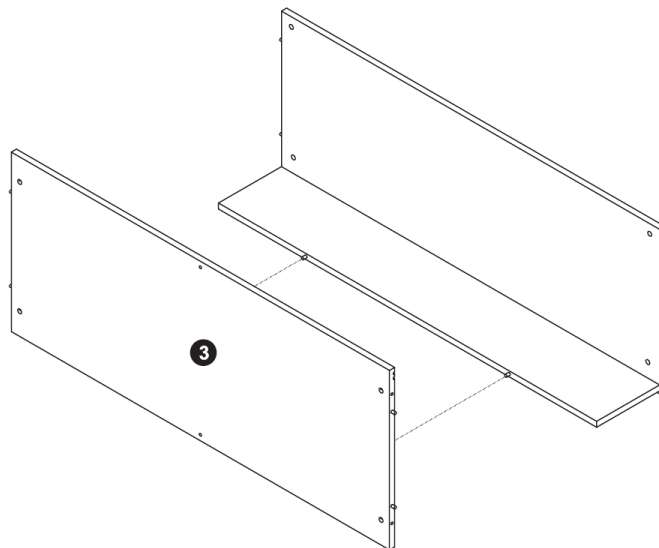

4.

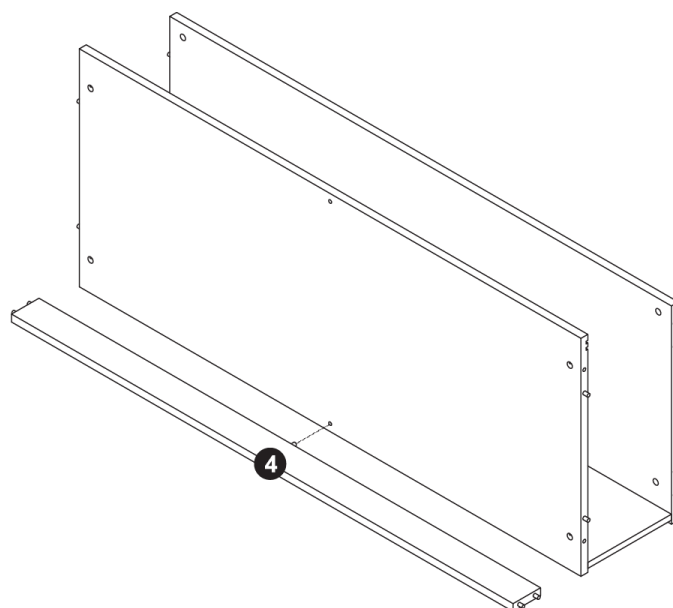

5.

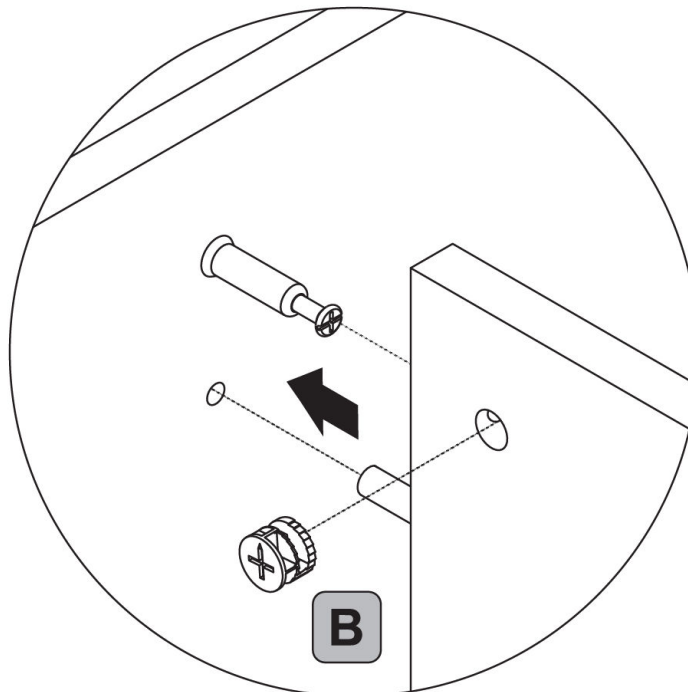
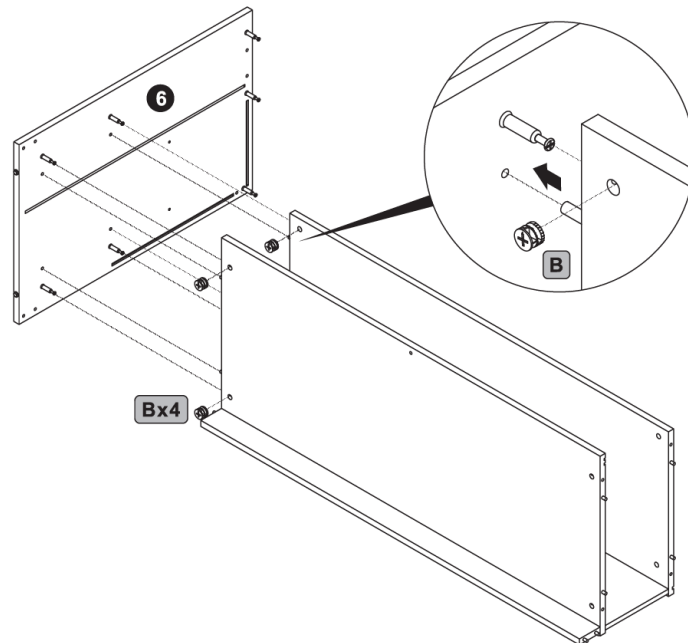

6.

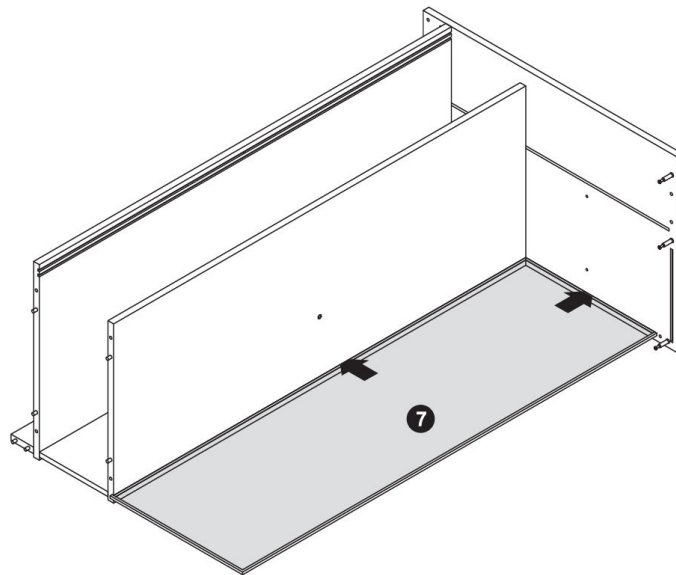

7.

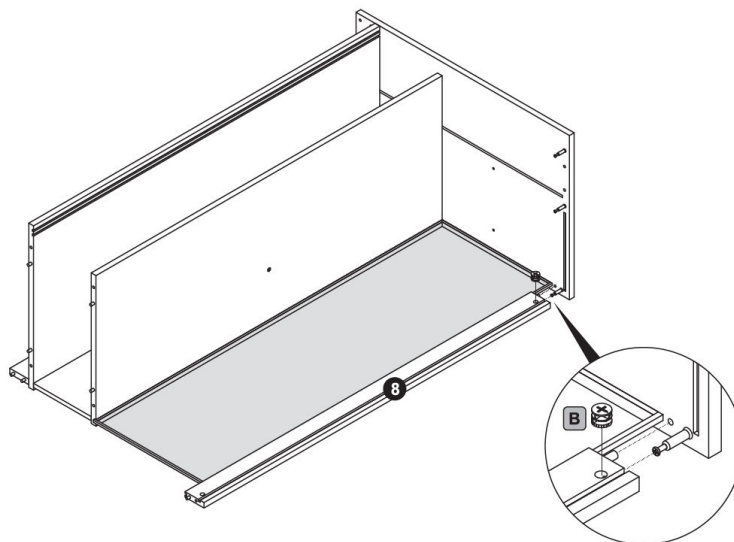

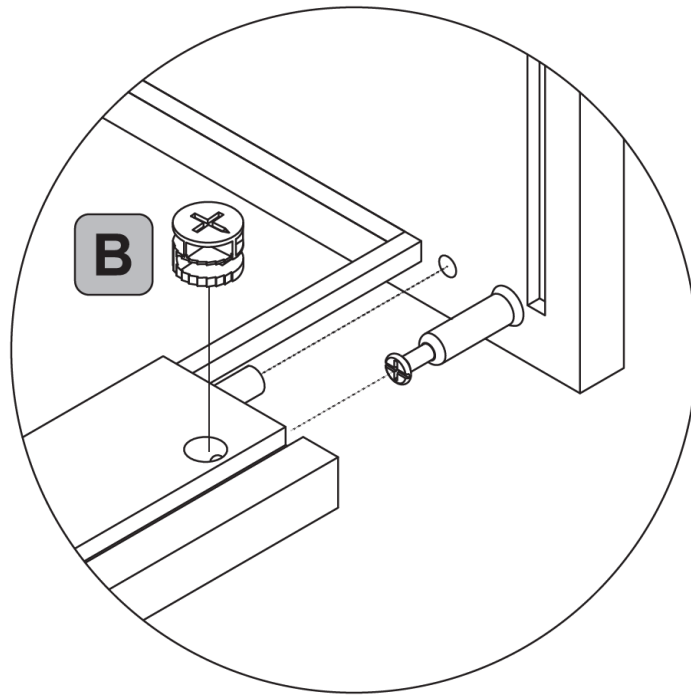

8.

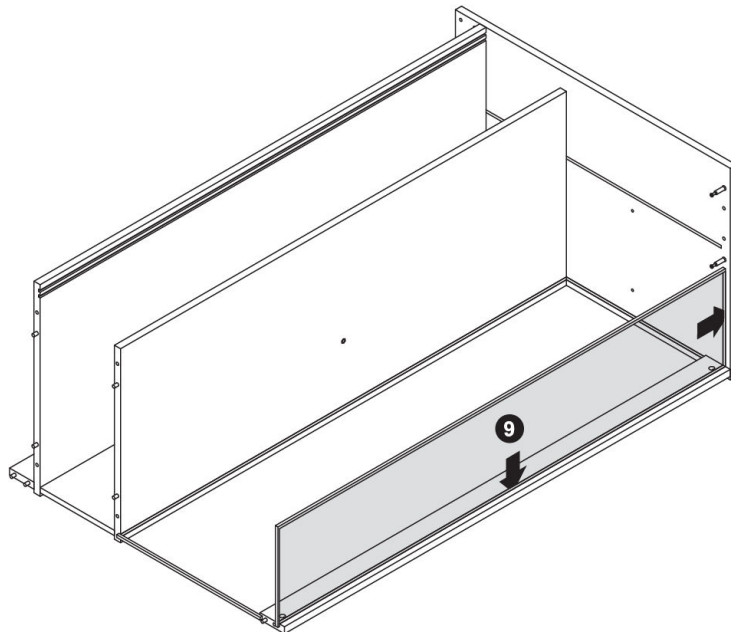

9.

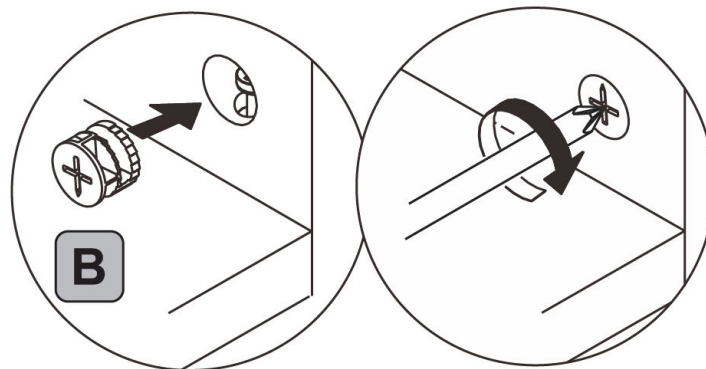
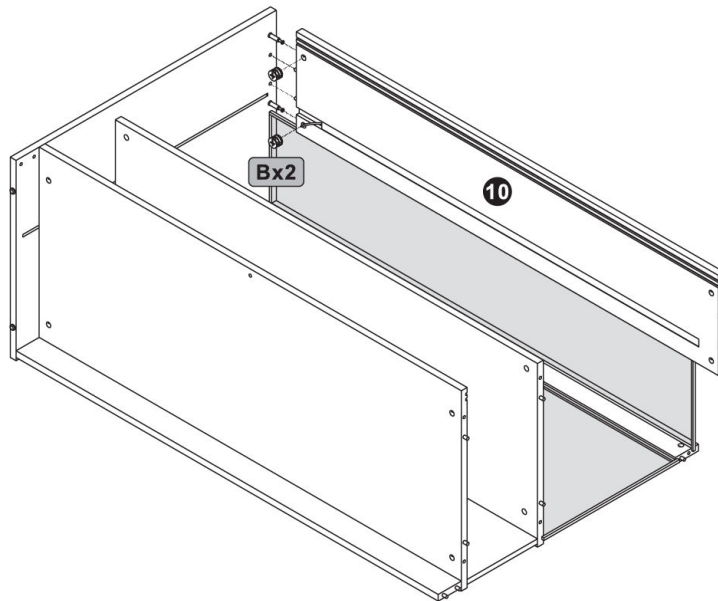

10.

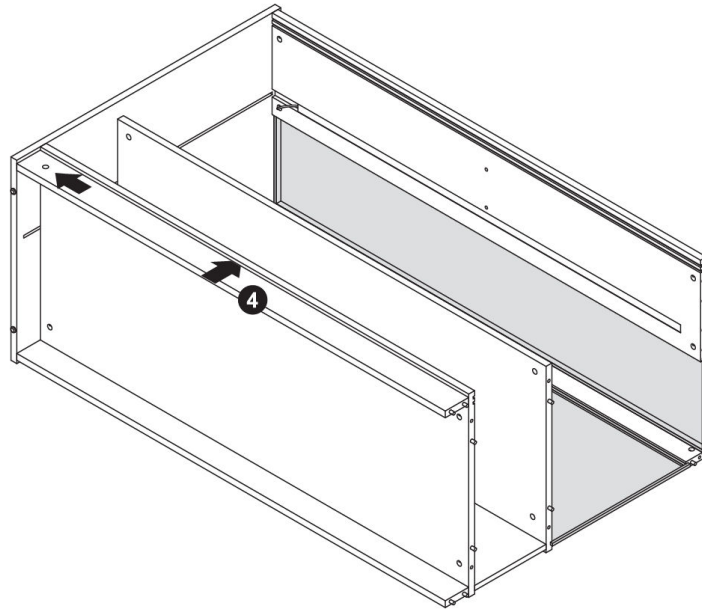

11.

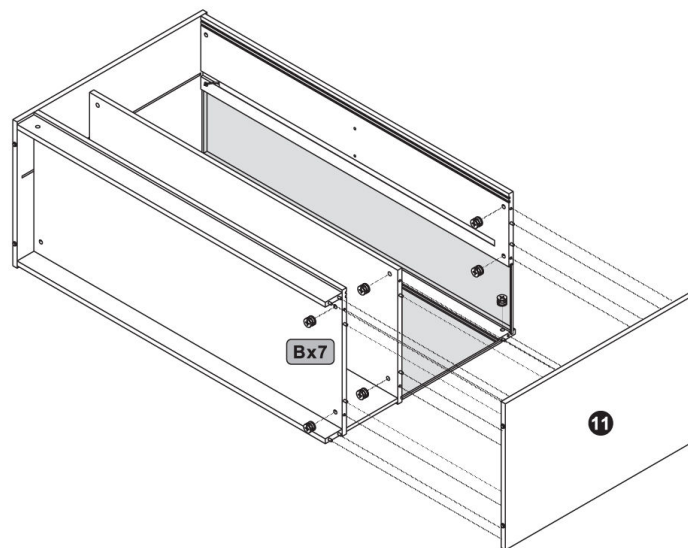

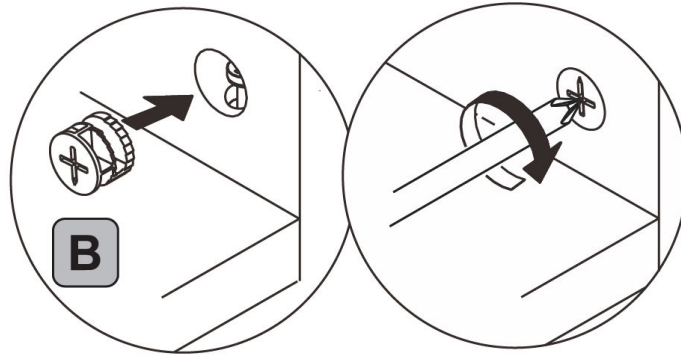

12.

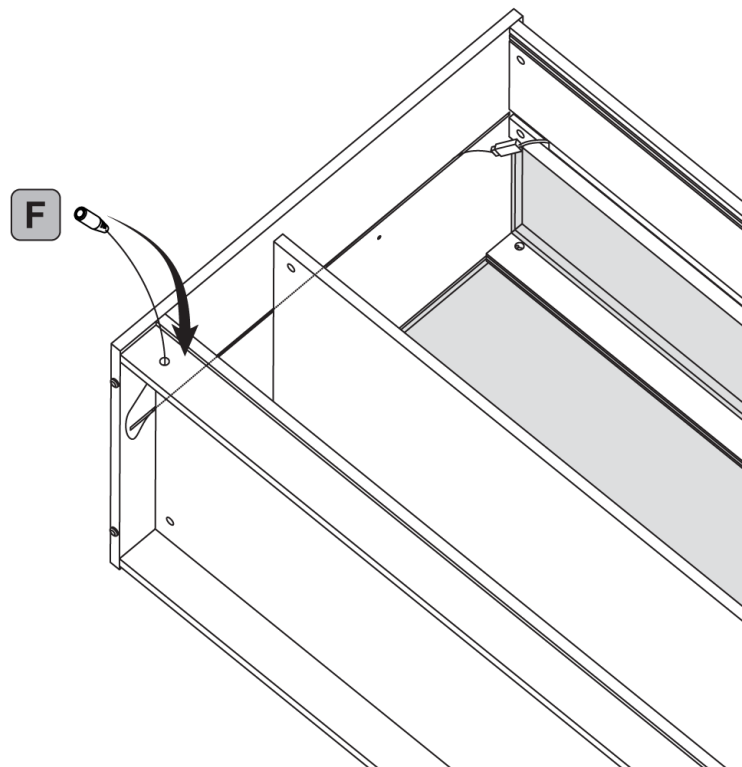

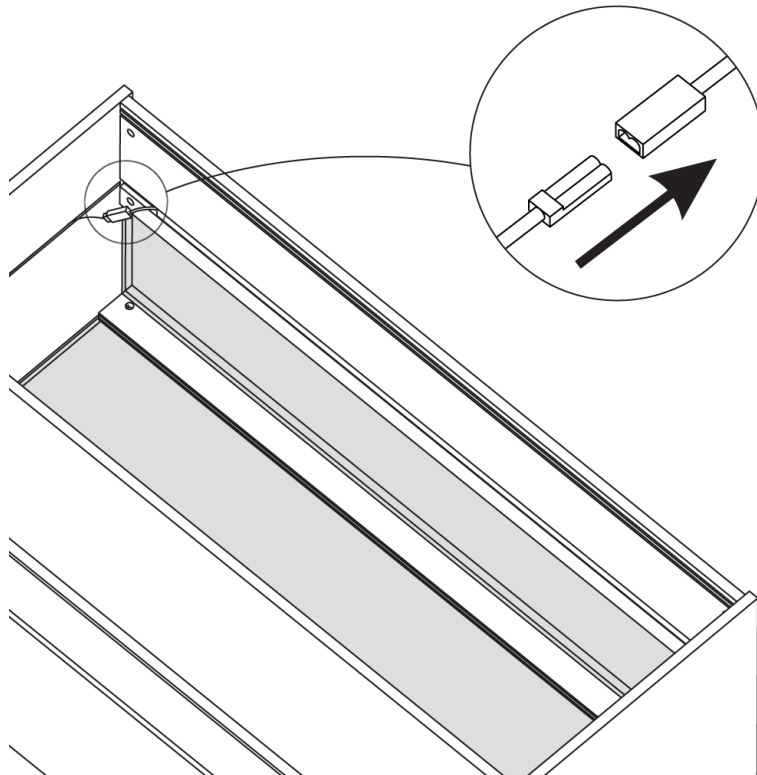

13.

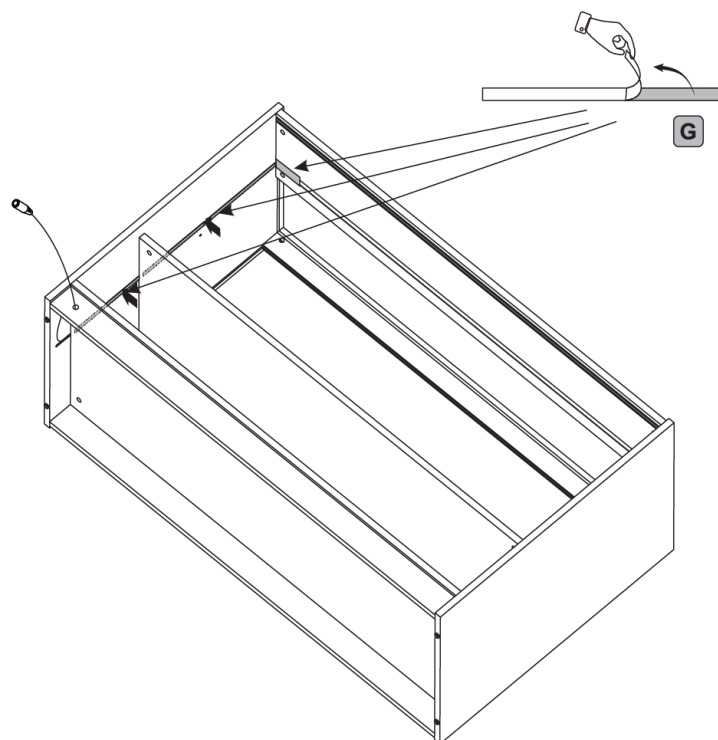

14.

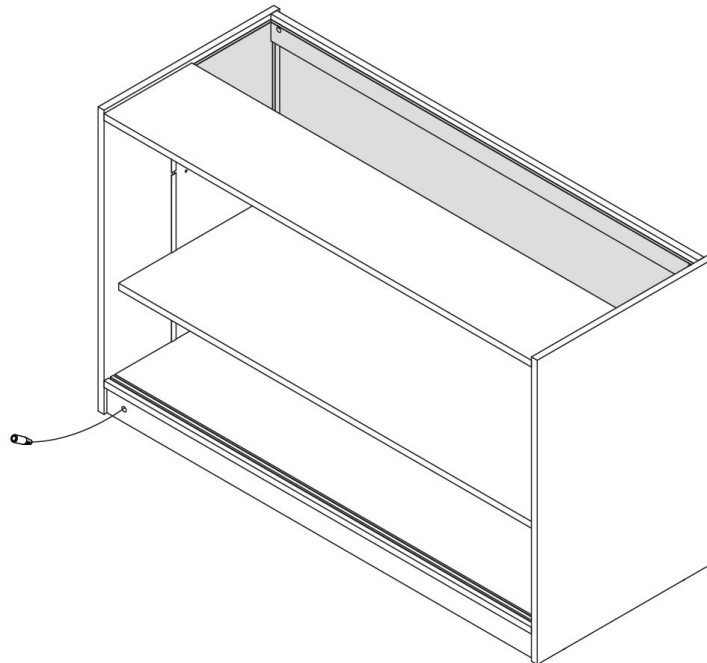

15.

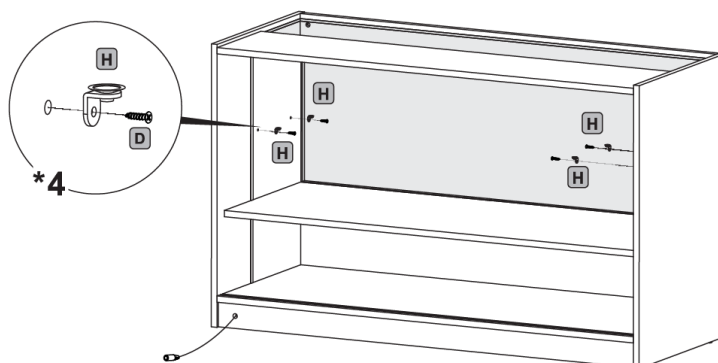

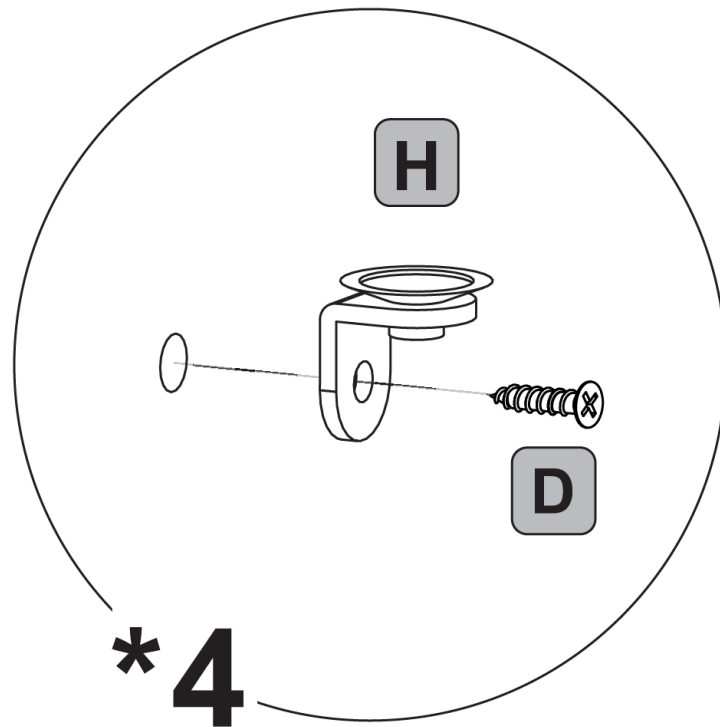

16.

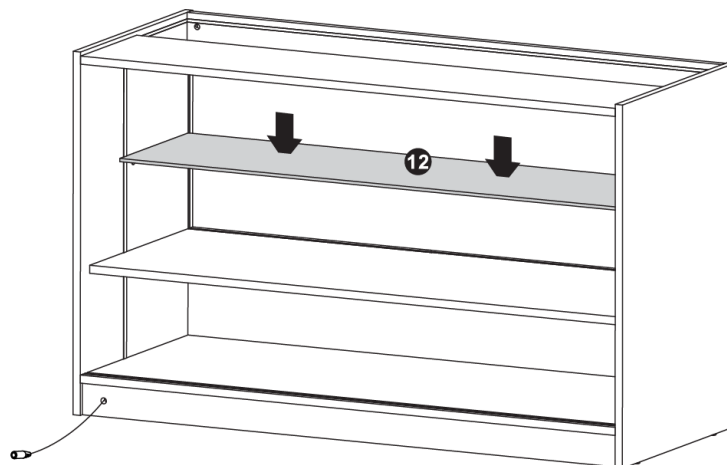

17.

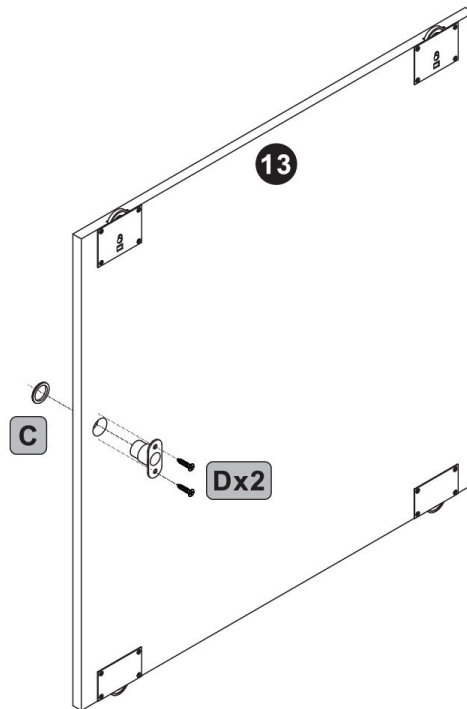

18.

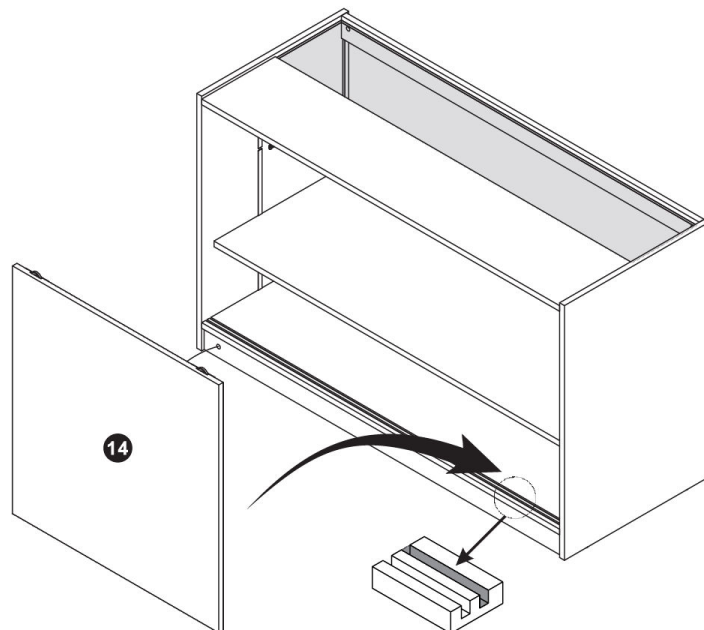

19.

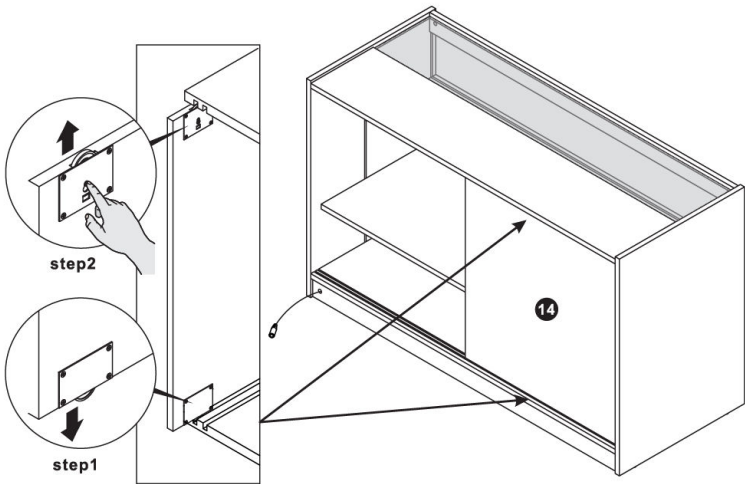
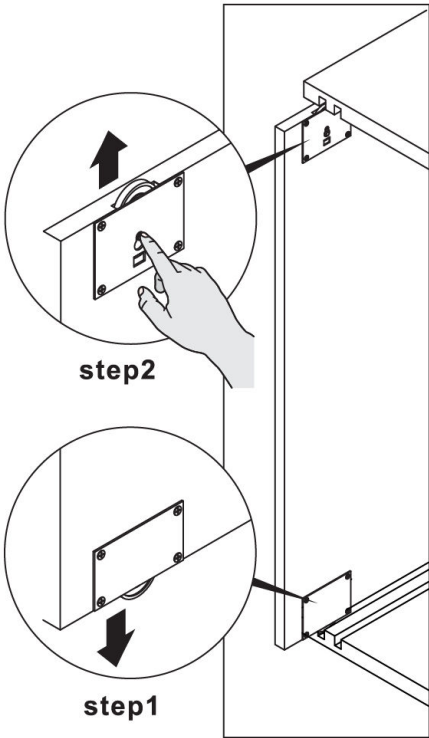

20.

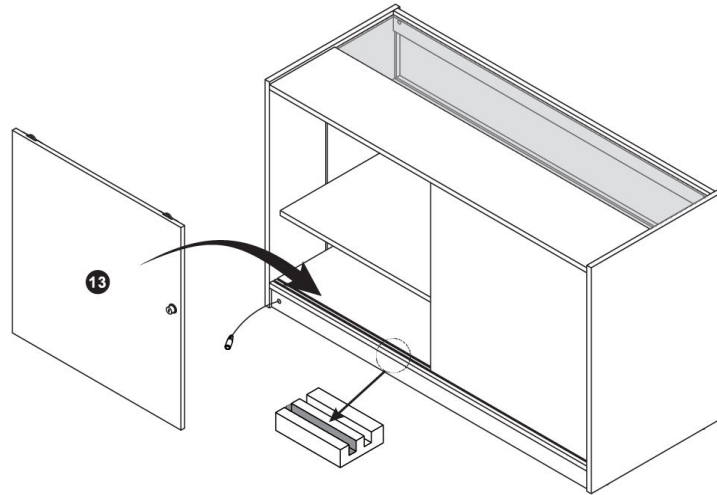

21.

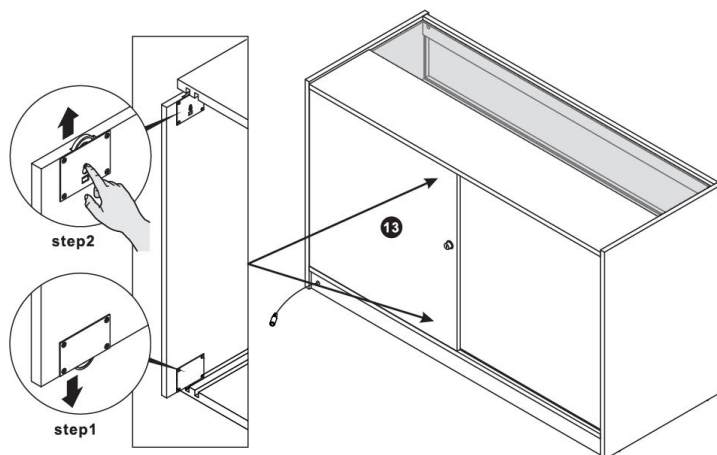

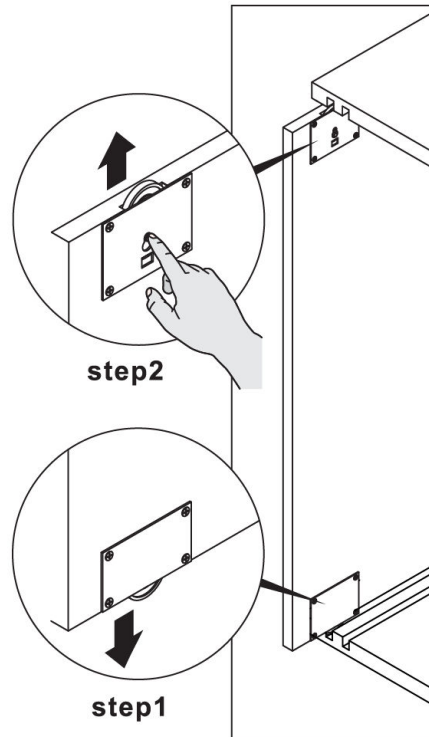

22.

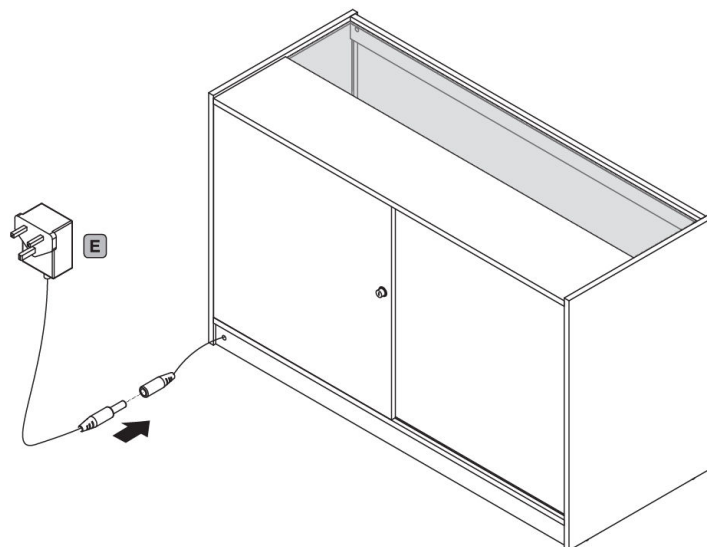

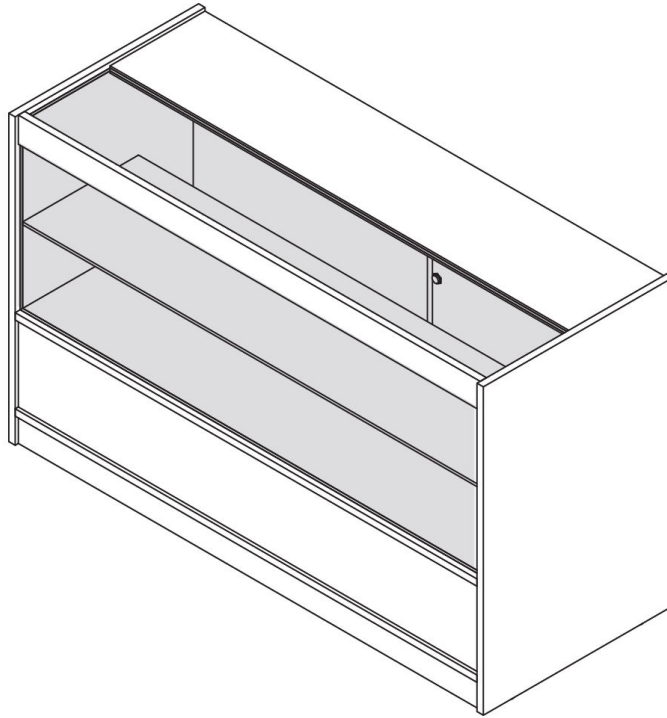
23.

24. Maintenance

- Clean the unit with a soft, damp cloth. Avoid using harsh chemicals or abrasive cleaners, which could damage the laminate or glass surfaces.
- Clean the glass shelves with appropriate glass-cleaning products to maintain visibility and avoid streaks.

25. Troubleshooting

- **WHAT DO I DO IF THERE ARE MISSING PARTS FROM MY ORDER?**

If there appears to be any part missing from your order, contact our friendly and helpful Customer Support Team within 7 days of receipt.

- **FOR ALL OTHER ISSUES, PLEASE CONTACT OUR CUSTOMER SUPPORT TEAM.**



