

A StepAlong by Monstershop

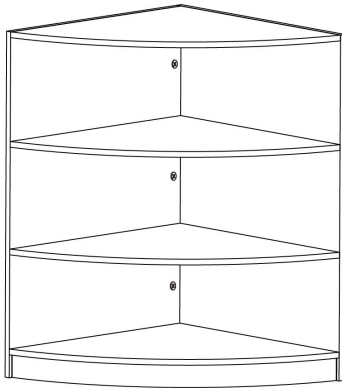

LM60 Shop Counter

204100, 204101, 214589

Unit Overview

This corner till unit is a versatile and stylish solution for maximising display and storage space in your retail environment. It can be effortlessly combined with any of the range of shop counters to form a larger 'L'-shaped configuration, or it can stand proudly on its own as an attractive and functional feature. With four display surfaces—three open shelves and the top section—you'll have plenty of space to showcase products to maximum effect.

The unit's sleek, curved frontage and wood-effect laminate finish lend it a modern yet professional look that enhances the overall aesthetic of your shop. Whether you're using it to display products or placing it near your point of sale for easy access to essentials like plastic bags, till rolls, or even a well-stocked coffee supply, this corner unit combines style and practicality perfectly. Available in black, white, and maple, it's designed to complement any retail setup.

Dimensions

LM60 Dimensions:

- **Product Height:** 0.9m
- **Product Depth:** 0.6m
- **Product Width:** 0.6m
- **Internal Shelf Heights:** 24.5cm



Safety Advice

- Make sure the unit is positioned on a flat, stable surface to prevent wobbling or tipping.
- If placing the unit on uneven flooring, use appropriate levelling methods to secure the unit.
- Do not exceed the specified weight limits for the shelves and surfaces to avoid damage to the unit or risk of injury.
- Ensure products are evenly distributed across shelves to prevent tipping or overloading.
- Ensure that children do not climb or play on the unit to prevent accidents or injury.
- Regularly inspect for any wear, such as loose screws or weak joints, and tighten or repair as necessary.
- Be cautious when handling items on glass shelves. Do not overload the shelves beyond their stated capacity, as this could lead to cracking or shattering.
- There may be debris and/or sawdust in the pre-drilled holes. Remove this before commencing with assembly. Use gloves to remove it.

Parts

1 - Side Panel

1 Piece(s)



2 - Side Panel

1 Piece(s)



3 - Shelves

3 Piece(s)



4 - Bottom Shelf

1 Piece(s)



5 - Kick Plate

1 Piece(s)



A - Connector Screw

19 Piece(s)



B - Cam Lock

19 Piece(s)



Steps (7)

1.

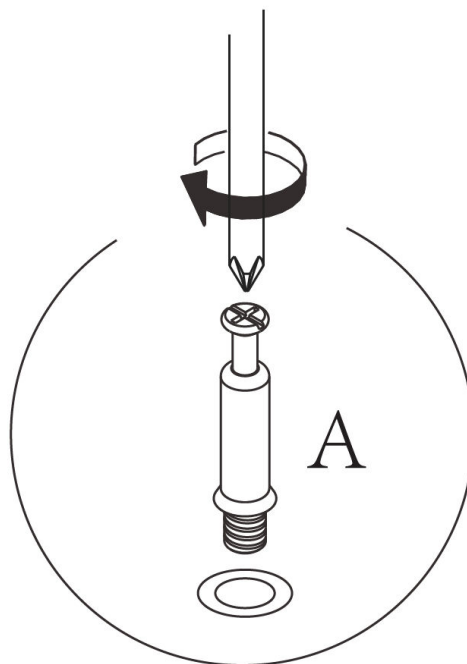
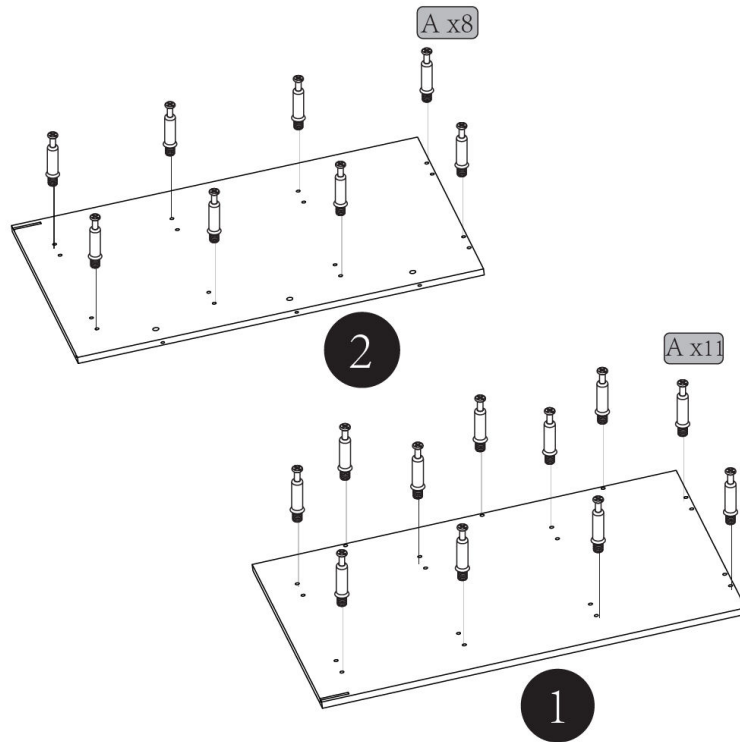

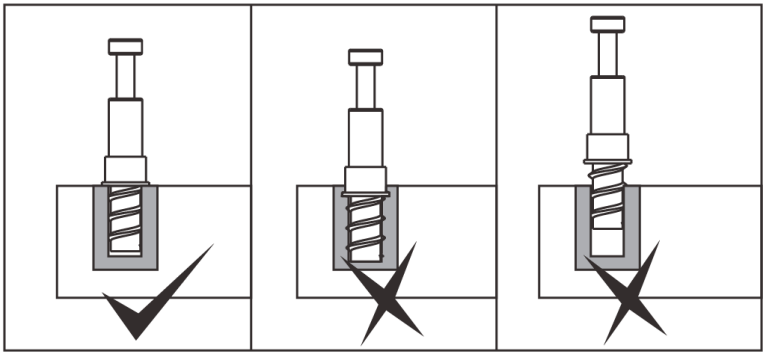

2.

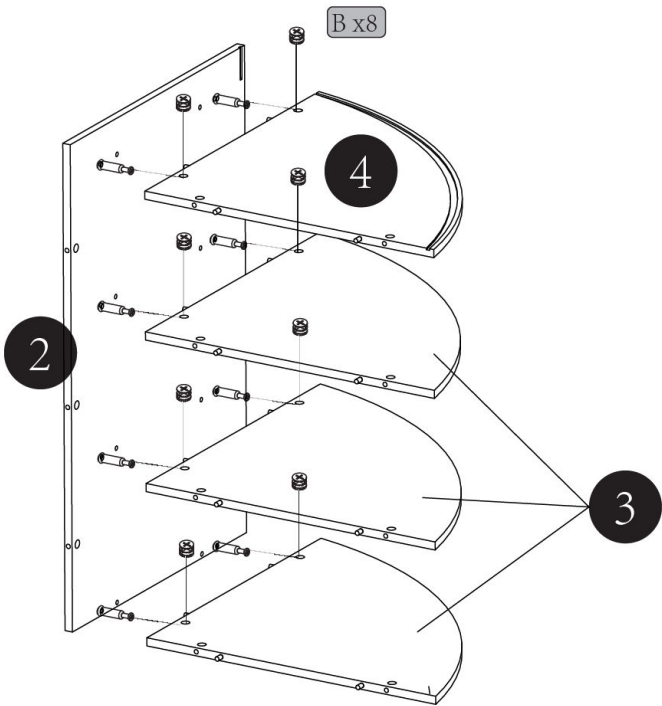

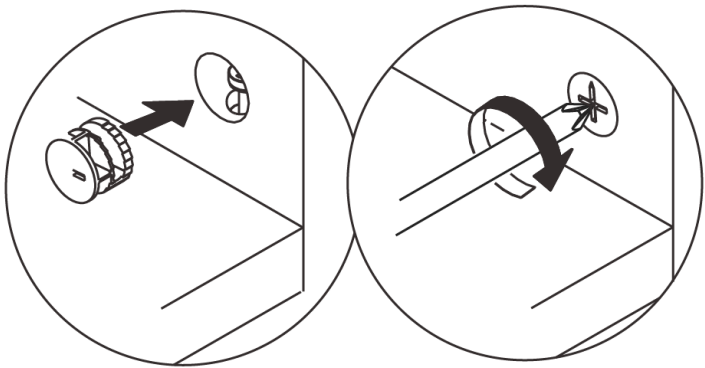

3.

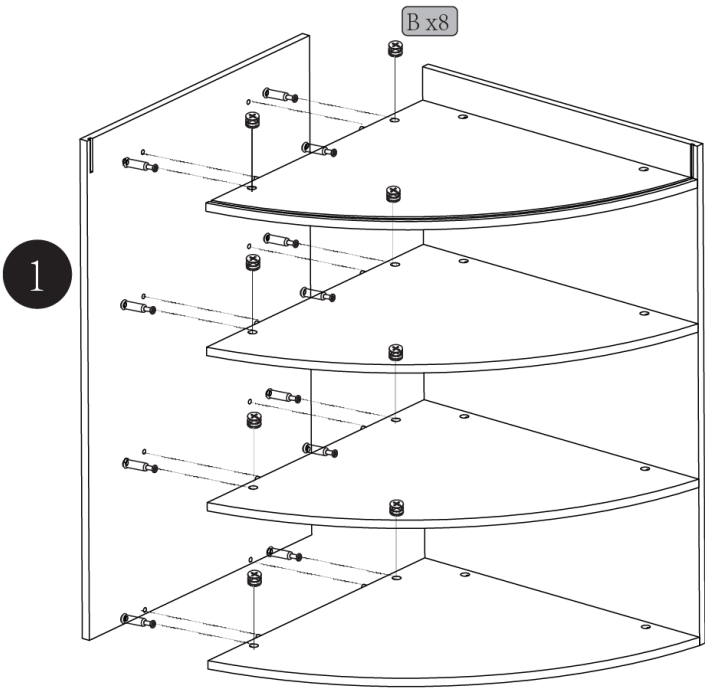

4.

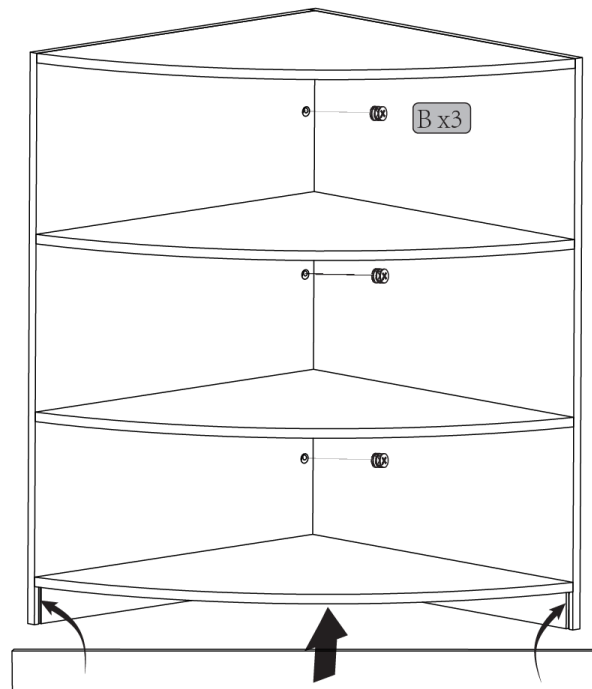

5.

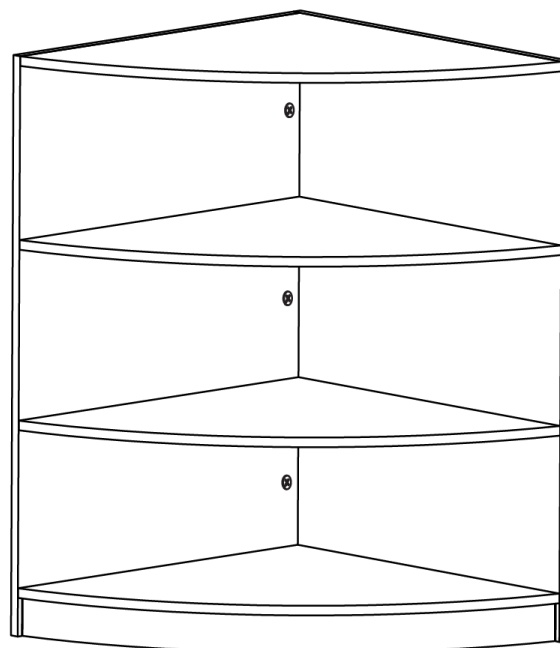

6. Maintenance

- Clean the unit with a soft, damp cloth. Avoid using harsh chemicals or abrasive cleaners, which could damage the laminate or glass surfaces.

7. Troubleshooting

- **WHAT DO I DO IF THERE ARE MISSING PARTS FROM MY ORDER?**

If there appears to be any part missing from your order, contact our friendly and helpful Customer Support Team within 7 days of receipt.

- **FOR ALL OTHER ISSUES, PLEASE CONTACT OUR CUSTOMER SUPPORT TEAM.**



A StepAlong by Monstershop

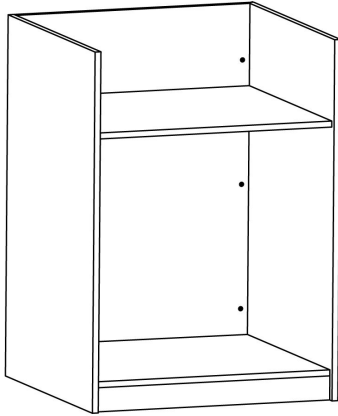

TB60 Shop Counter

204102, 204103, 214588

Unit Overview

Elevate your point of sale with the sleek and functional TB60 till block. Designed with a recessed top shelf, this unit provides the perfect space for your cash register and card machine, ensuring easy access and an ergonomic setup for smooth customer transactions. Beneath the till, a spacious storage area offers plenty of room to discreetly stow essential items such as plastic bags, till rolls, gift wrap, or even a small bin to keep your workspace neat and organised.

Built to handle the weight of even the heaviest payment systems, the TB60 combines sturdy construction with a stylish laminate finish in maple, black, or white. Its clean, professional design seamlessly fits into any retail environment, helping staff present a polished and organised appearance while working behind the counter.

Dimensions

TB60 Dimensions:

- **Product Height:** 0.9m
- **Product Depth:** 0.6m
- **Product Width:** 0.6m
- **Storage Area Dimensions:** 56.4cm wide x 63.2cm high
- **Till Area Dimensions:** 56.4cm wide x 17.3cm high
- **Product Net Weight:** 30.1KG



- **2 Colours:** Black, White

Safety Advice

- Make sure the unit is positioned on a flat, stable surface to prevent wobbling or tipping.
- If placing the unit on uneven flooring, use appropriate levelling methods to secure the unit.
- Do not exceed the specified weight limits for the shelves and surfaces to avoid damage to the unit or risk of injury.
- Ensure products are evenly distributed across shelves to prevent tipping or overloading.
- Ensure that children do not climb or play on the unit to prevent accidents or injury.
- Regularly inspect for any wear, such as loose screws or weak joints, and tighten or repair as necessary.
- Be cautious when handling items on glass shelves. Do not overload the shelves beyond their stated capacity, as this could lead to cracking or shattering.
- There may be debris and/or sawdust in the pre-drilled holes. Remove this before commencing with assembly. Use gloves to remove it.

Parts

A – Front Panel

1 Piece(s)



C – Kick Plate

1 Piece(s)



E – Side Panel

1 Piece(s)



B – Shelf Panels

2 Piece(s)



D – Side Panel

1 Piece(s)



1 – Connector Screw

14 Piece(s)



2 - Cam Lock

14 Piece(s)



Steps (6)

1.

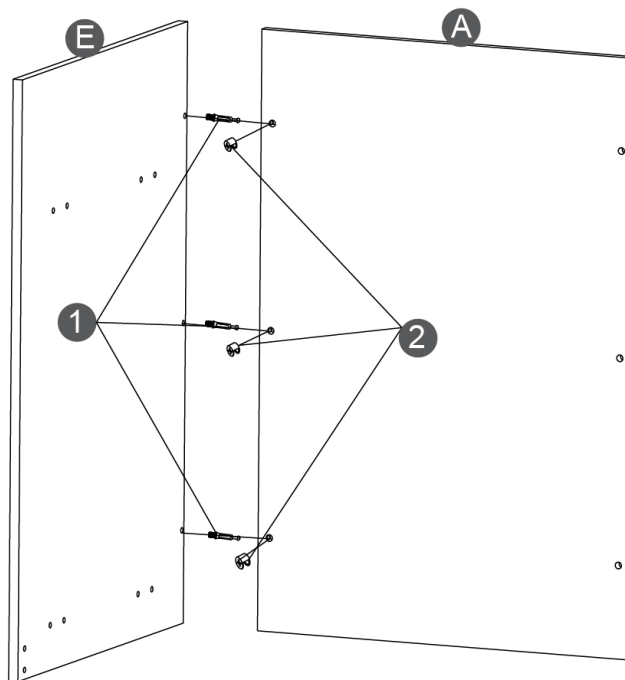

2.

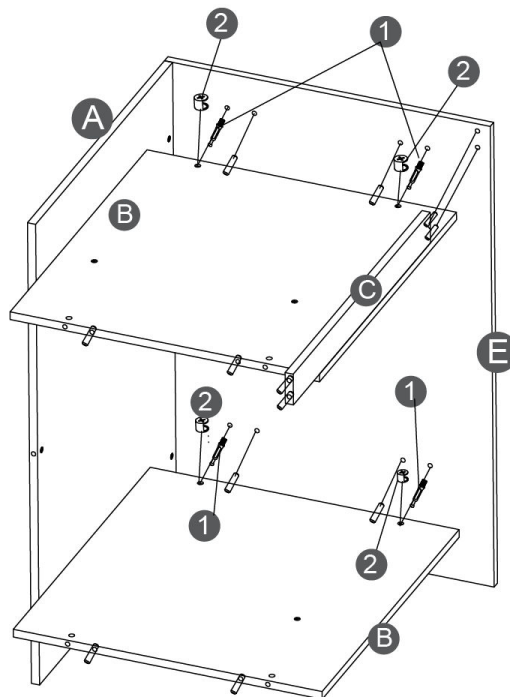

3.

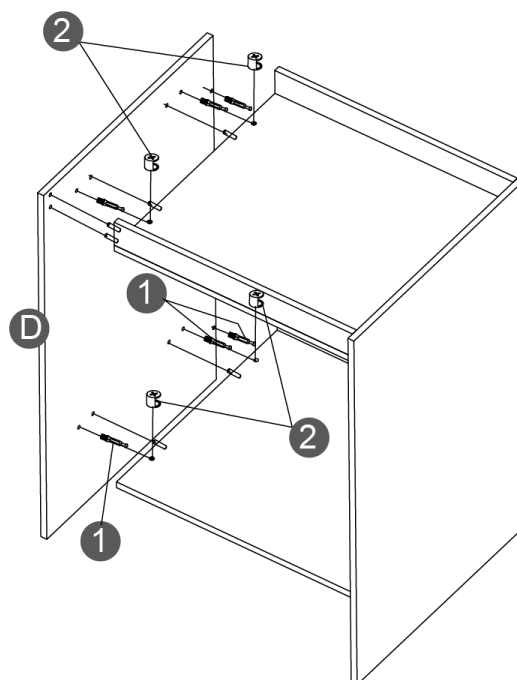

4.

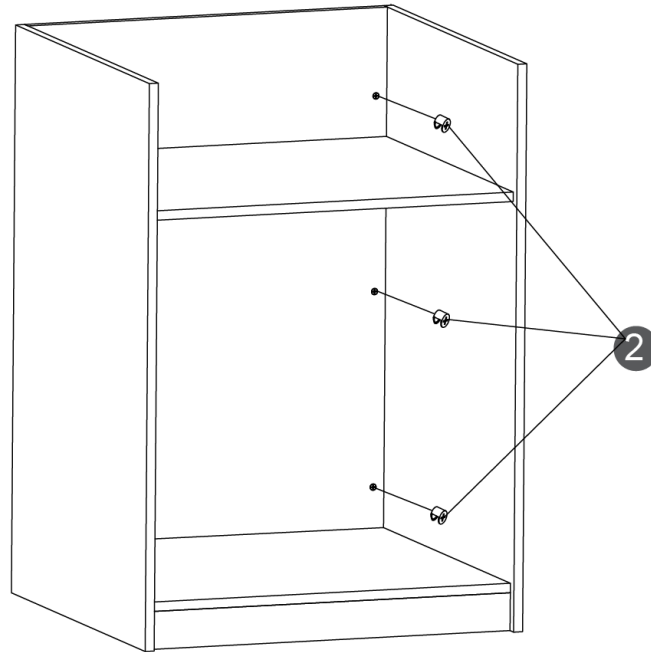

5. Maintenance

- Clean the unit with a soft, damp cloth. Avoid using harsh chemicals or abrasive cleaners, which could damage the laminate or glass surfaces.

6. Troubleshooting

- **WHAT DO I DO IF THERE ARE MISSING PARTS FROM MY ORDER?**

If there appears to be any part missing from your order, contact our friendly and helpful Customer Support Team within 7 days of receipt.

- **FOR ALL OTHER ISSUES, PLEASE CONTACT OUR CUSTOMER SUPPORT TEAM.**

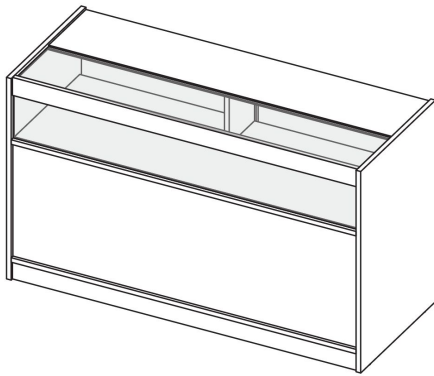

A StepAlong by Monstershop

**B900-1200 LED Shop Counter**

204104/204105/204106/204113/204114/204115

Unit Overview

The B retail counter is a sleek and functional unit, ideal for showcasing products while also offering secure storage. The top section features a glass front with a single shelf, illuminated by LED lighting to highlight your display items beautifully. Beneath the display area, hidden storage provides space for stock or supplies, safely secured with lockable doors. The durable laminate finish ensures long-lasting use and easy maintenance. Available in black, white, and maple, this counter is designed to enhance any retail environment by combining display and storage with added security and style.

Dimensions**B900 Dimensions:**

- **Product Height:** 0.9m
- **Product Depth:** 0.6m
- **Product Width:** 0.9m
- **Top Shelf Max Storage Height:** 24.3cm
- **Middle Shelf Max Storage Height:** 24.2cm
- **Bottom Shelf Max Storage Height:** 24.3cm
- **Keys Included:** 2
- **3 Colours:** Black, Maple, White
- **Net Weight:** 64.4g



B1200 Dimensions:

- **Product Height:** 0.9m
- **Product Depth:** 0.6m
- **Product Width:** 1.2m
- **Top Shelf Max Storage Height:** 24.3cm
- **Middle Shelf Max Storage Height:** 24.2cm
- **Bottom Shelf Max Storage Height:** 24.3cm
- **Keys Included:** 2
- **3 Colours:** Black, Maple, White
- **Net Weight:** 81.2kg

Specifications**B900 Specifications:**

- **Length of LED Strip:** 700MM
- **Power (W):** 5.3W
- **Power Supply (Input Voltage):** 100~240V
- **Voltage:** 12V
- **Brightness (Lumen):** 221.1LM
- **Colour Temperature (K):** 6489K
- **Lifespan (Hours):** 30000H
- **Operating Temperature Range:** '-20 ~ 50

B1200 Specifications:

- **Length of LED Strip:** 1000MM
- **Power (W):** 7.2W
- **Power Supply (Input Voltage):** 100~240V
- **Voltage:** 12V
- **Brightness (Lumen):** 296.1LM
- **Colour Temperature (K):** 6432K



- **Lifespan (Hours):** 30000H
- **Operating Temperature Range:** '-20 ~ 50

Safety Advice



- Please read through the Safe Working Practice to ensure prevention of injury or damage to the device.
- Make sure the unit is positioned on a flat, stable surface to prevent wobbling or tipping.
- If placing the unit on uneven flooring, use appropriate levelling methods to secure the unit.
- Do not exceed the specified weight limits for the shelves and surfaces to avoid damage to the unit or risk of injury.
- Ensure products are evenly distributed across shelves to prevent tipping or overloading.
- Ensure that children do not climb or play on the unit to prevent accidents or injury.
- Regularly inspect for any wear, such as loose screws or weak joints, and tighten or repair as necessary.
- There may be debris and/or sawdust in the pre-drilled holes. Remove this before commencing with assembly. Use gloves to remove it.



- Be cautious when handling items on glass shelves. Do not overload the shelves beyond their stated capacity, as this could lead to cracking or shattering.
- Always ensure the unit is properly plugged into a suitable power outlet with the correct voltage as indicated in the specifications.
- Do not allow the LED light strip to come into contact with water or moisture to avoid electrical hazards.
- Regularly inspect the LED strip and power cables for wear or damage. If any damage is noticed, immediately disconnect the power supply and seek professional assistance for repairs.
- Never attempt to modify or alter the electrical components or wiring of the LED light system.
- Ensure the power supply is switched off before performing any maintenance, cleaning, or adjusting of the LED lights.
- We recommend turning off the LED lights at the close of each business day to ensure energy efficiency and prolong the lifespan of the lights.
- Ensure proper ventilation around the LED lights to avoid overheating, especially if the unit is in constant use.
- Avoid covering or obstructing the LED lights to prevent overheating, which could shorten their lifespan or cause damage.



- Do not install the unit near any heat sources, such as radiators, as excessive heat can affect the longevity of the LED strip.
- Keep power cables and exposed lighting out of reach of children and animals to avoid accidental damage or injury.

Parts

1 - Front Panel

1 Piece(s)

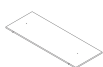

3 - Center Shelf

1 Piece(s)



5 - Lower Shelf

1 Piece(s)



7 - Front Glass Panel

1 Piece(s)

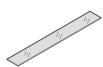

9 - Countertop Glass

1 Piece(s)

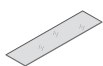

11 - Side Panel

1 Piece(s)

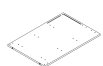

13 - Kick Plate

1 Piece(s)



15 - Door

1 Piece(s)



B - Cam Lock

18 Piece(s)



D - Phillips Head Screw

2 Piece(s)



2 - Upper Shelf

1 Piece(s)



4 - Shelf Support Panel

3 Piece(s)



6 - Side Panel

1 Piece(s)

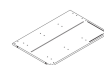

8 - Glass Mounting Bar

1 Piece(s)



10 - LED-Integrated Counter-top

1 Piece(s)



12 - Kick Plate with Cable Pass-Through

1 Piece(s)



14 - Door with Lock Slot

1 Piece(s)



A - Connector Screw

18 Piece(s)



C - Door Lock

1 Piece(s)



E - Power Adapter

1 Piece(s)



F - LED Extension Cable
1 Piece(s)



G - Slot Cover Strip
8 Piece(s)



Steps (24)

1.

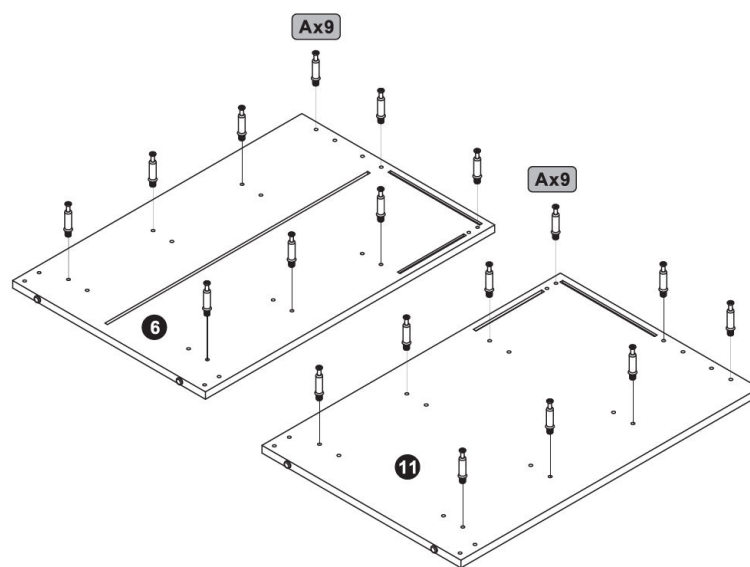

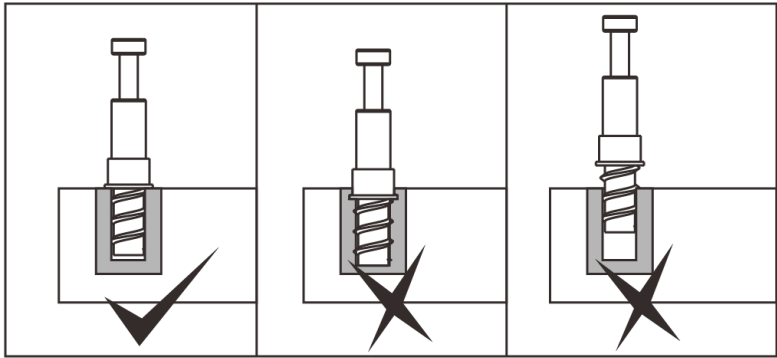
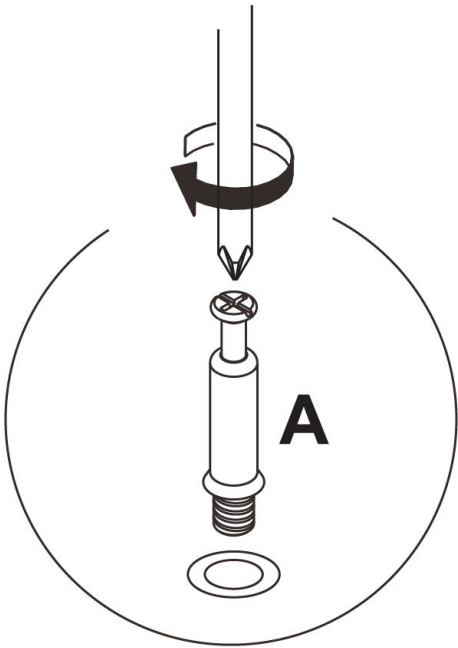

2.

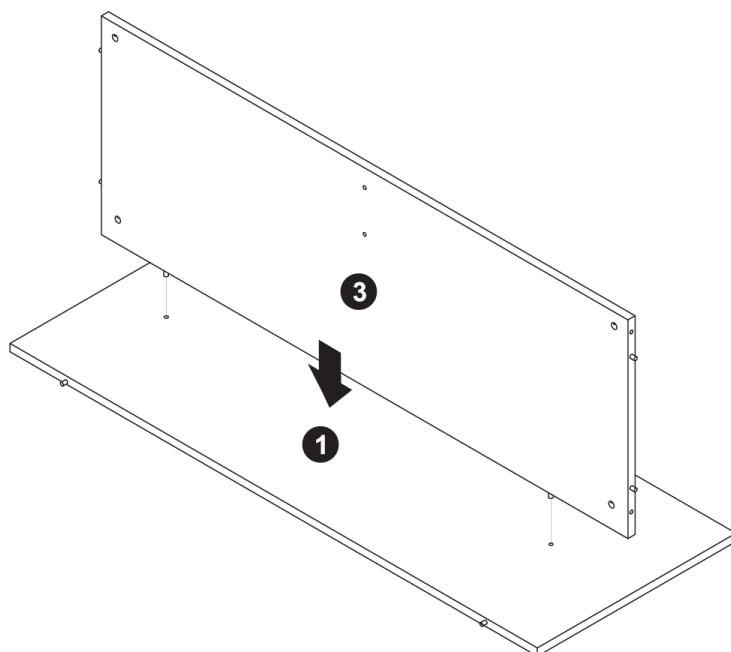

3.

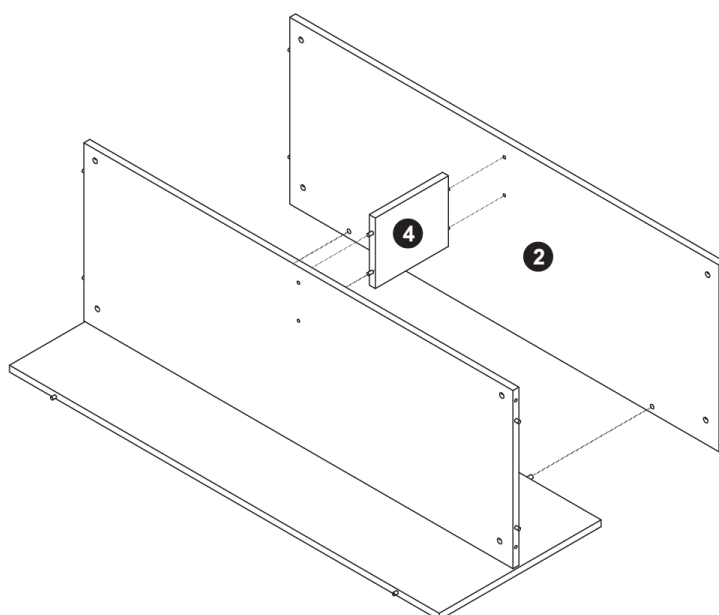

4.

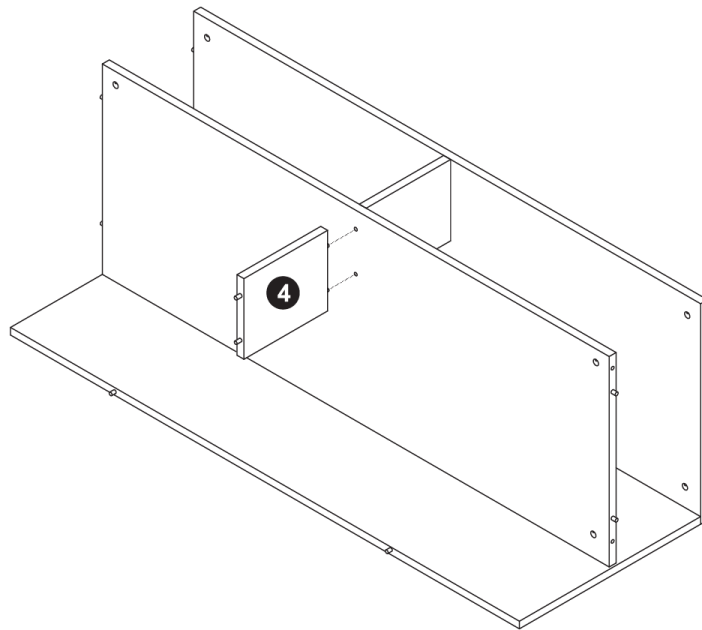

5.

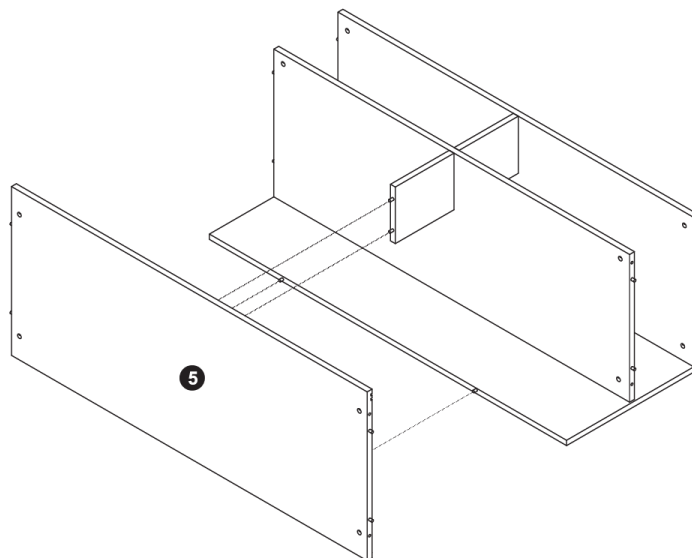

6.

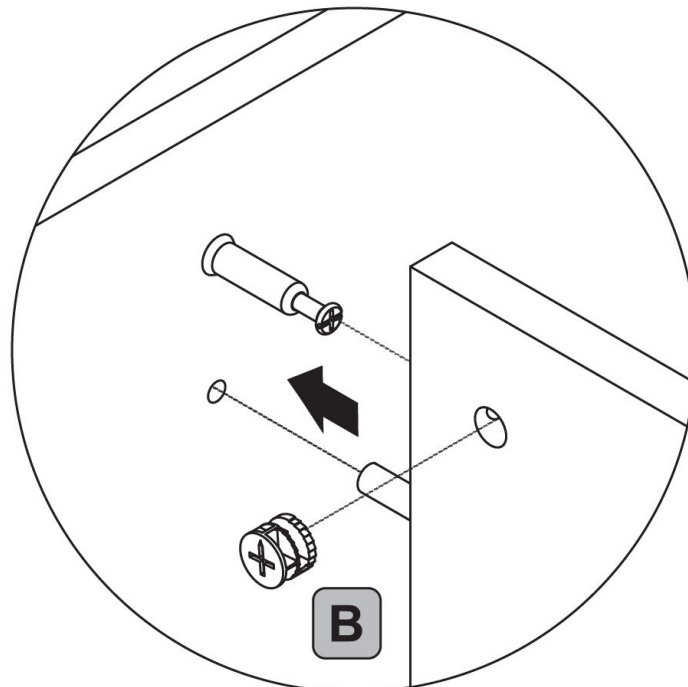
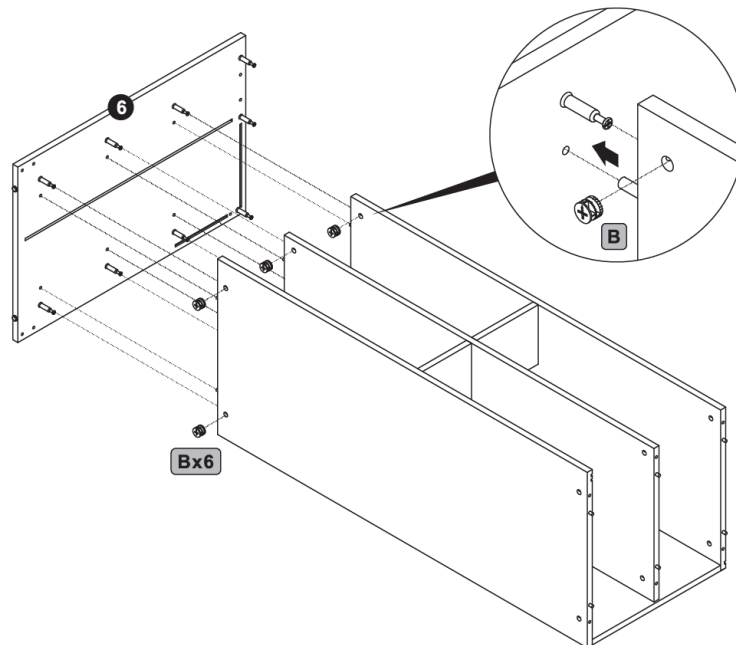

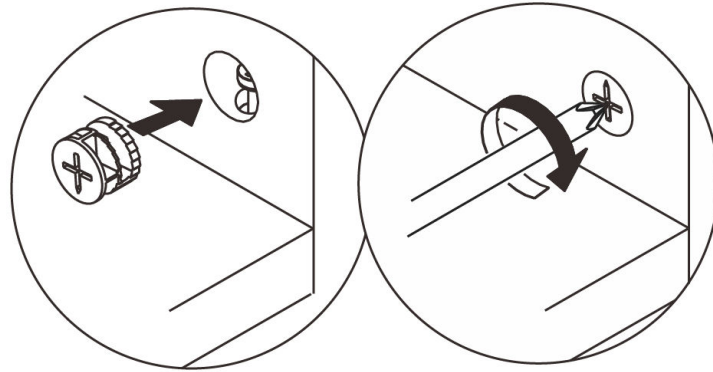

7.

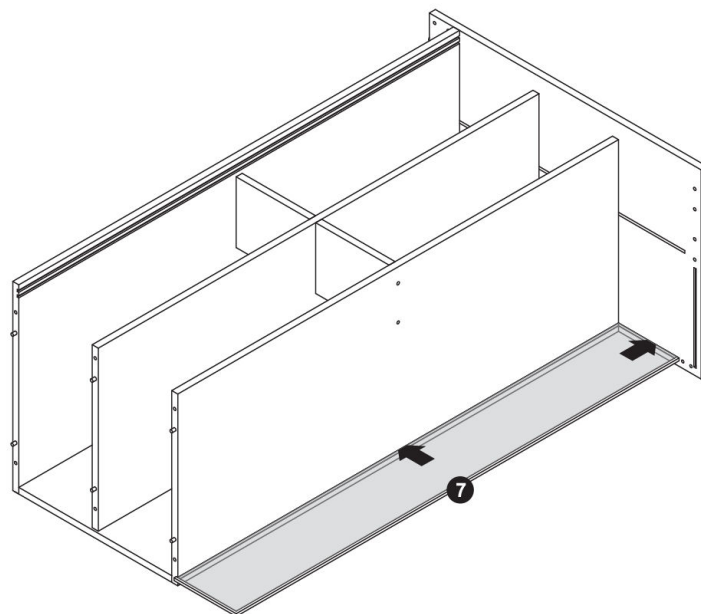

8.

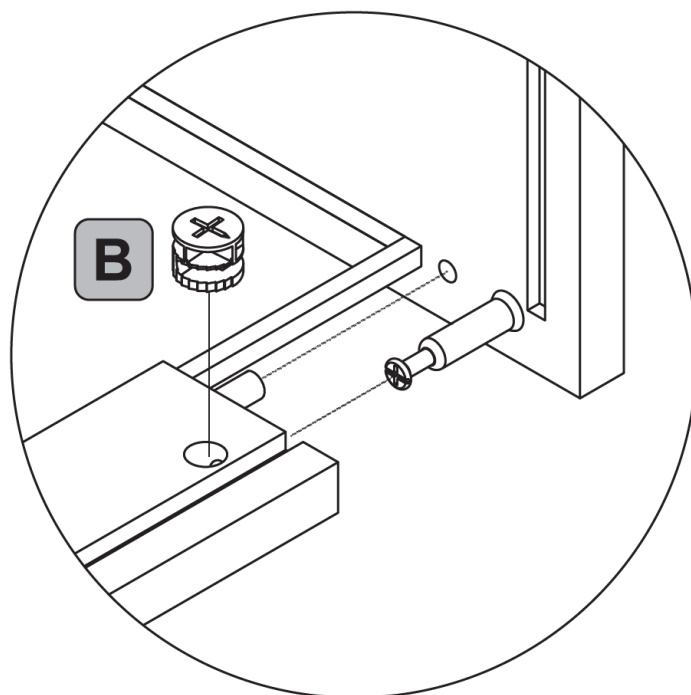
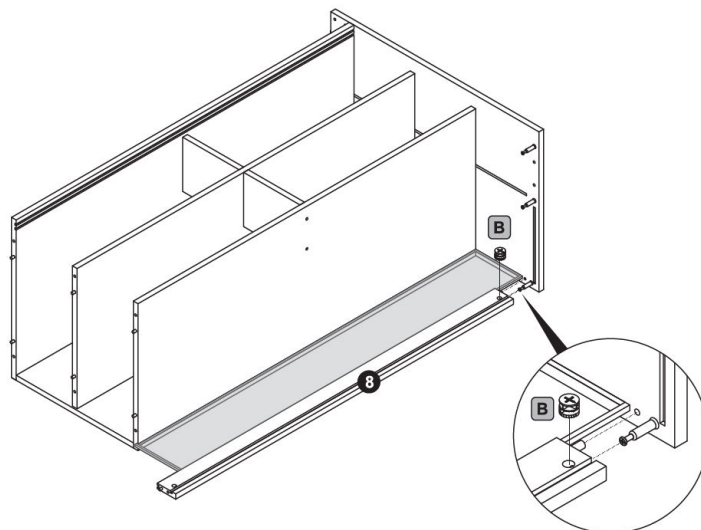

9.

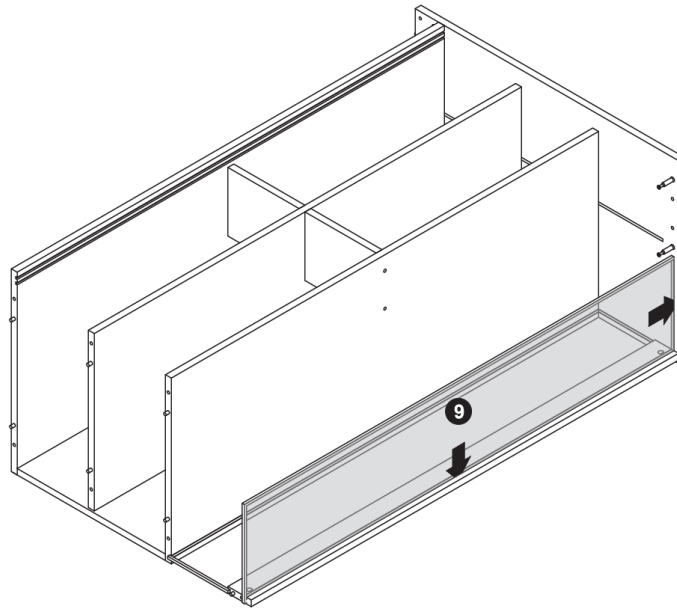

10.

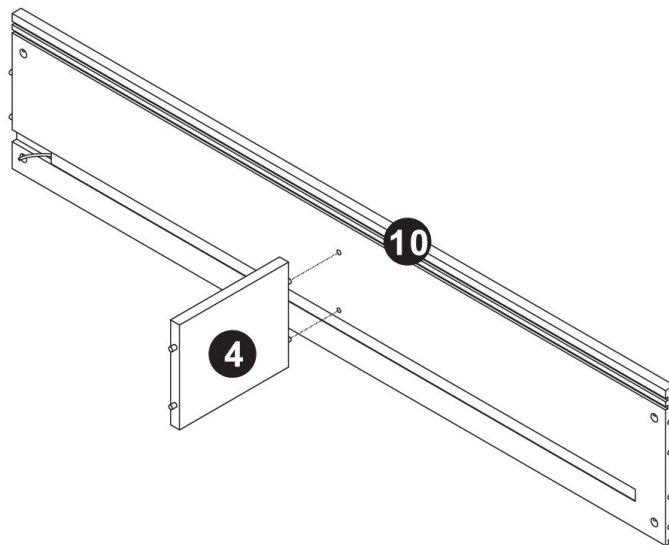

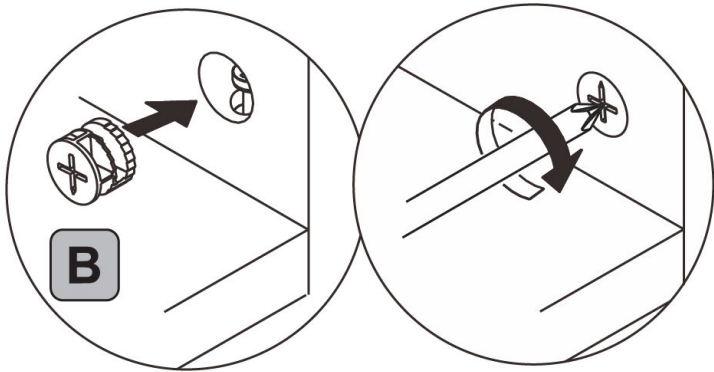
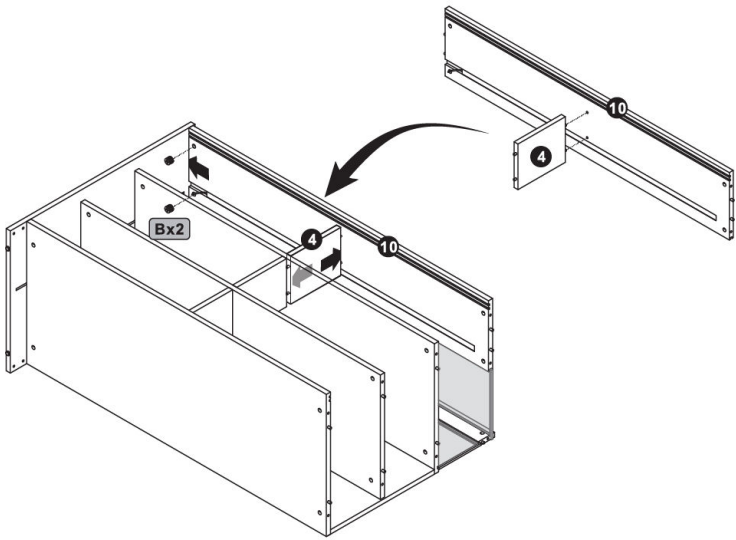

11.

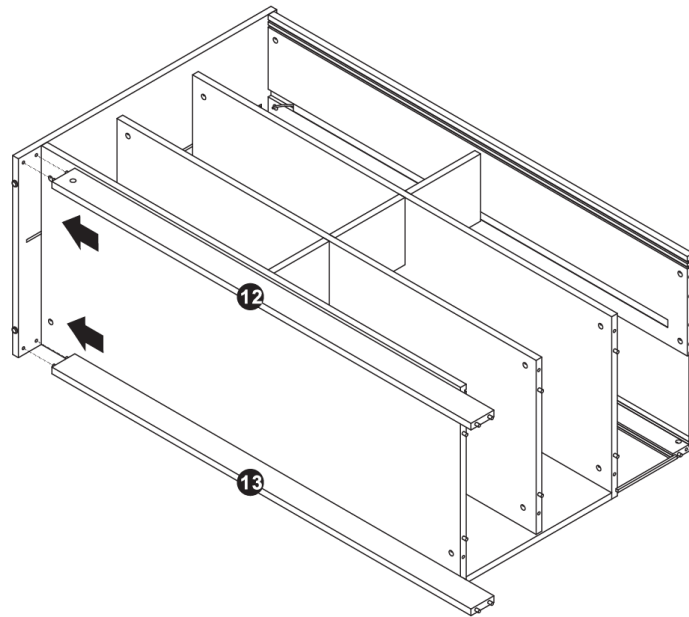

12.

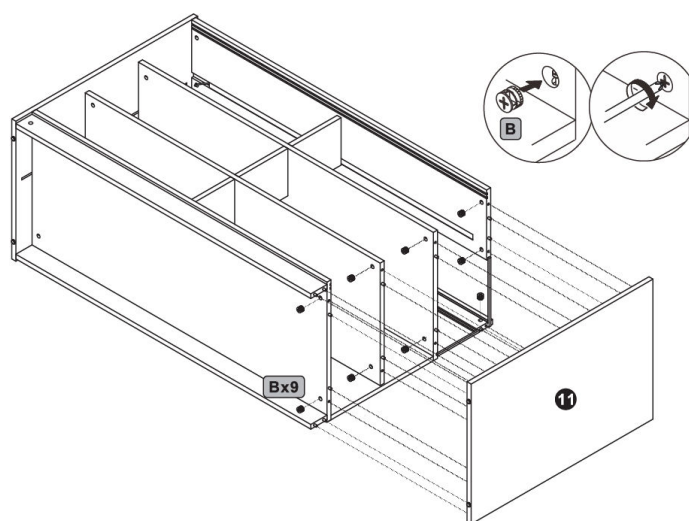

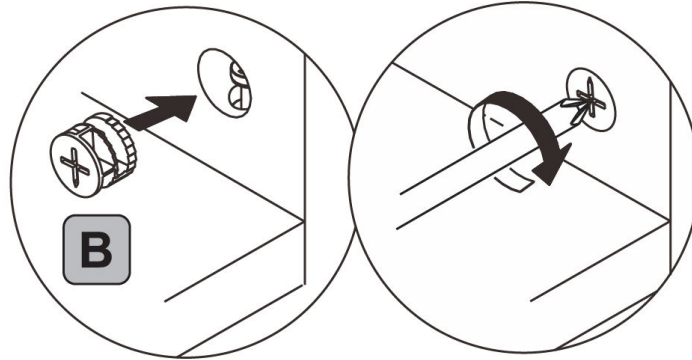

13.

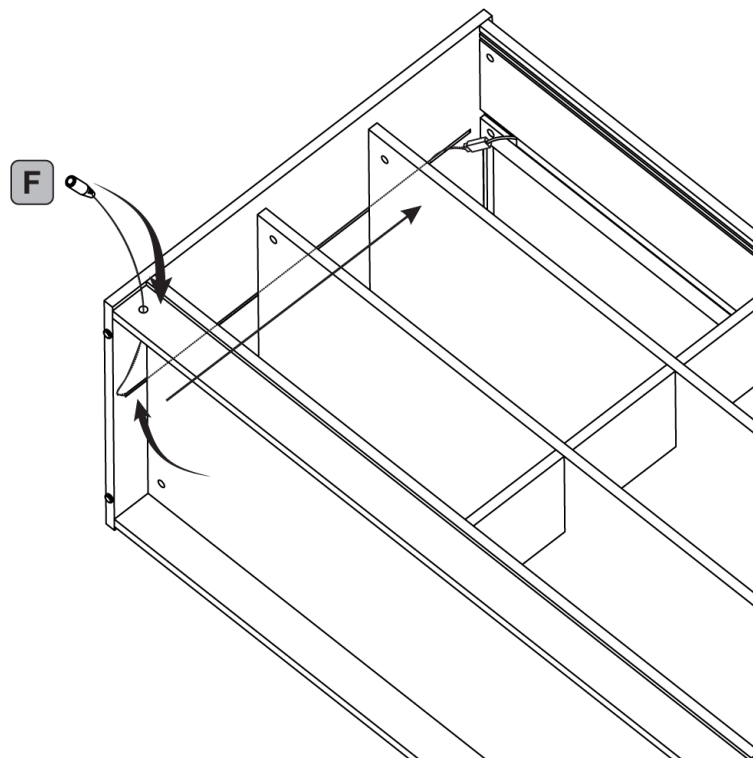

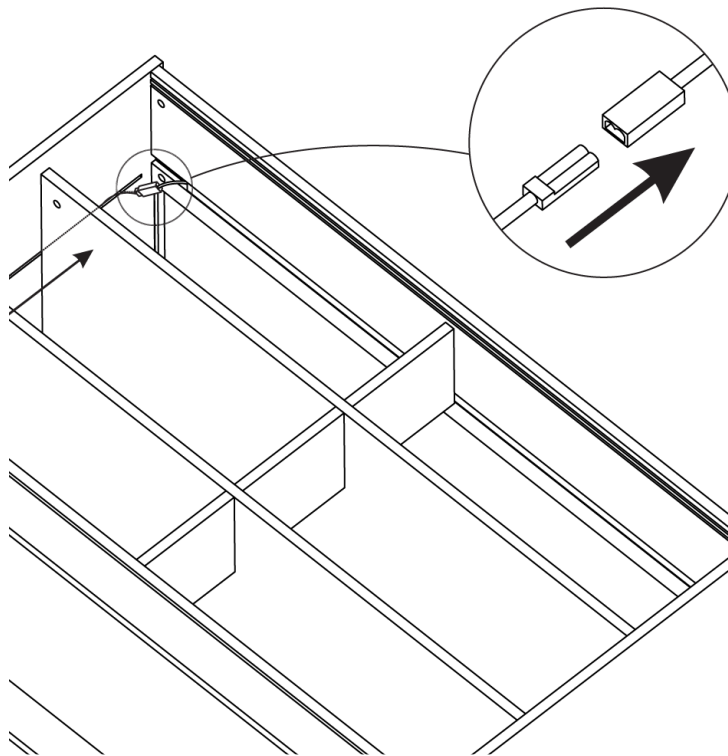

14.

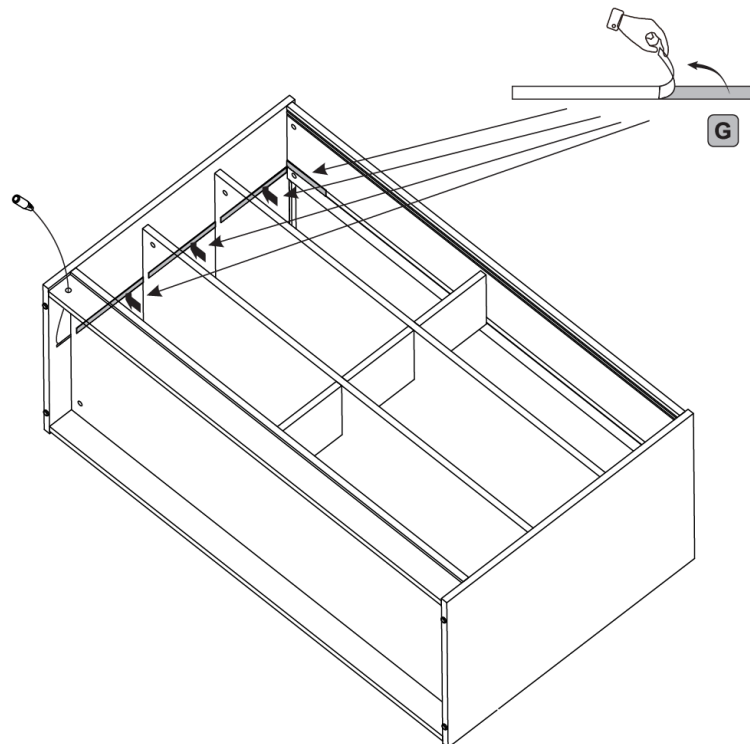

15.

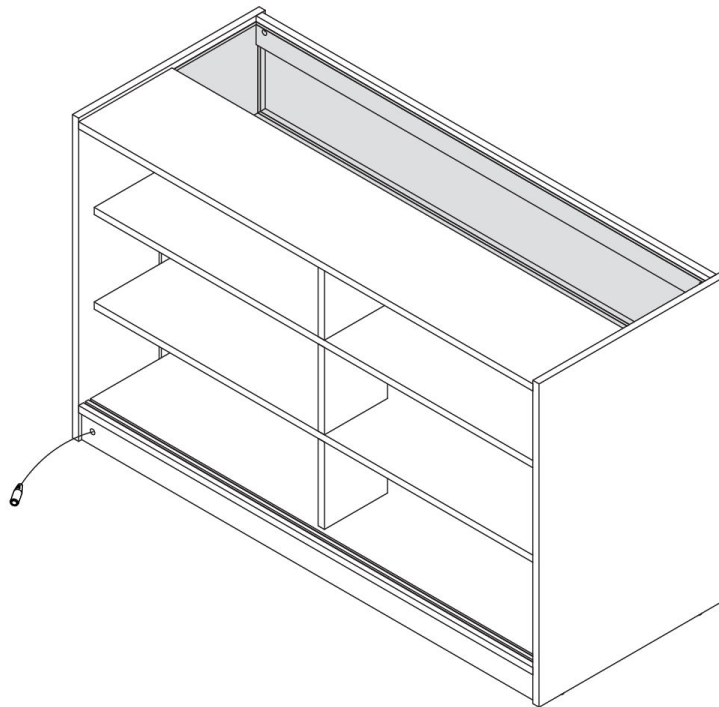

16.

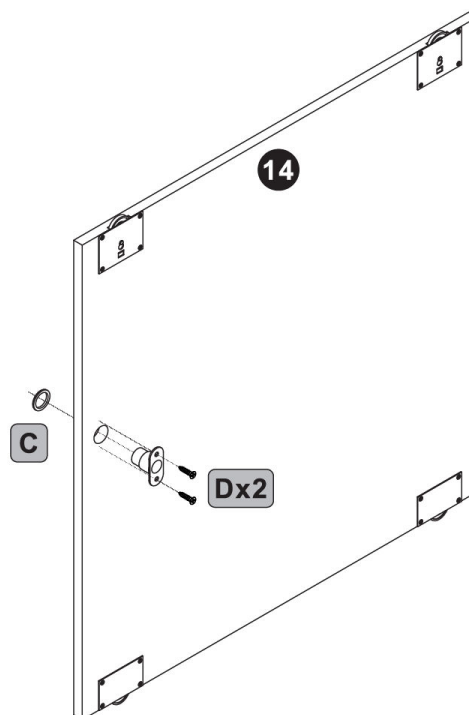

17.

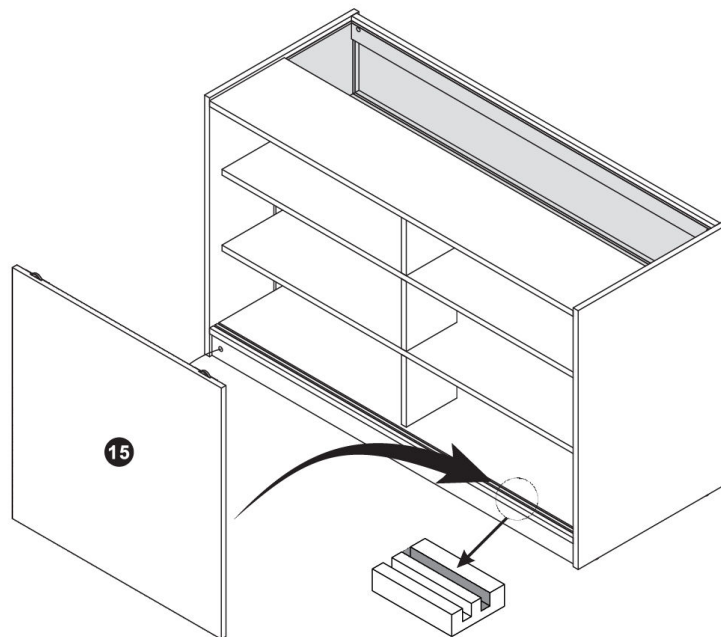

18.

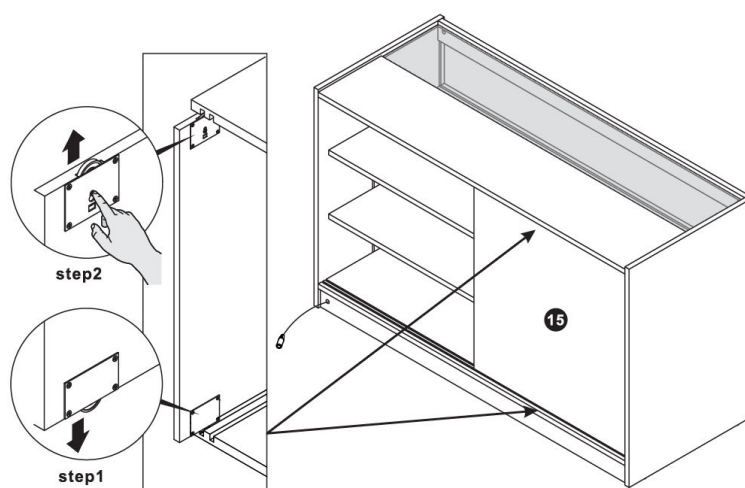

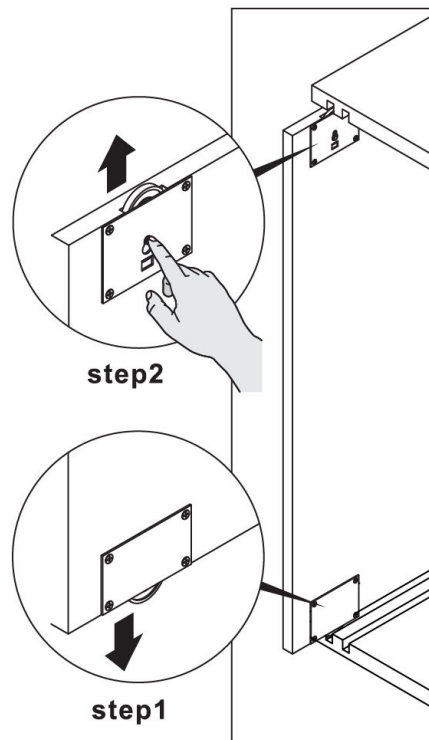

19.

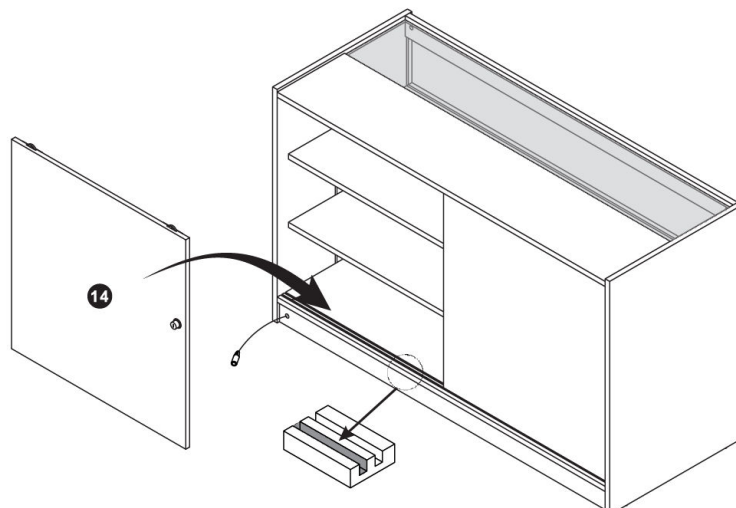

20.

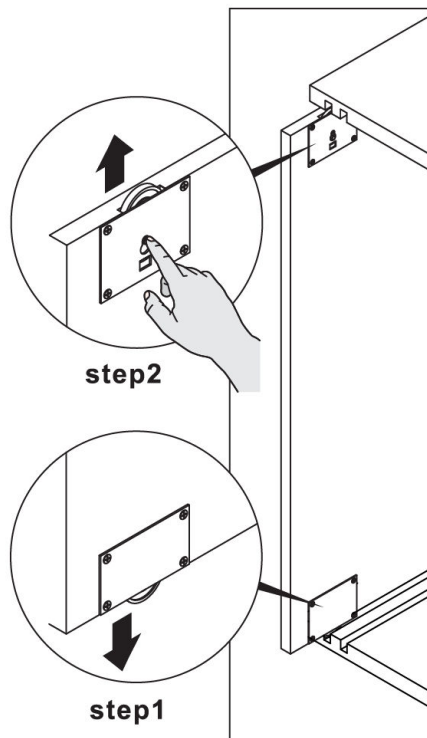
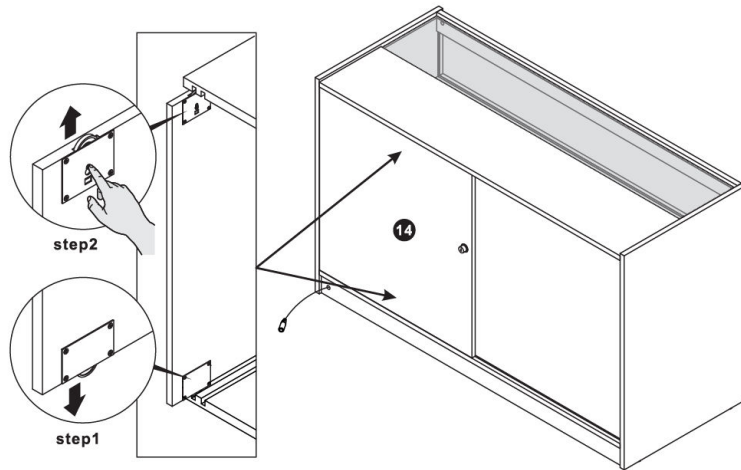

21.

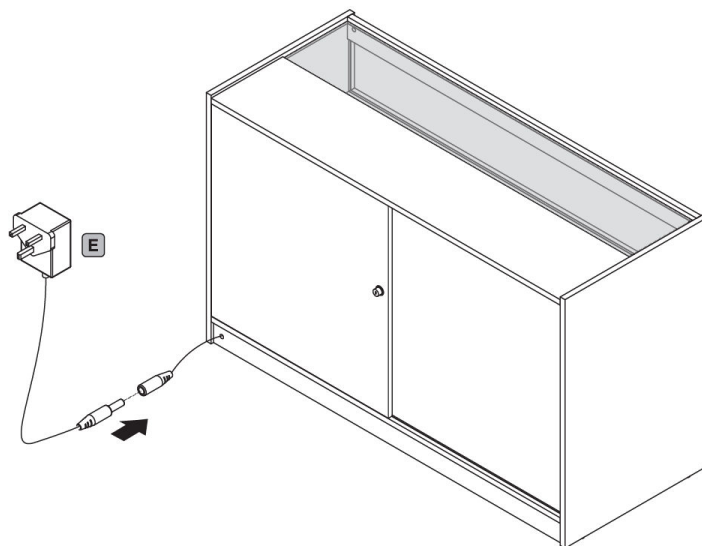

22.

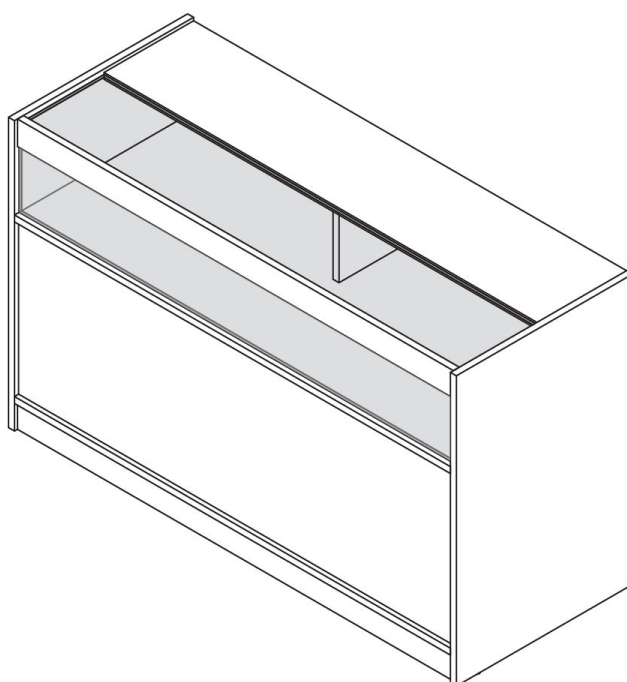

23. Maintenance

- Clean the unit with a soft, damp cloth. Avoid using harsh chemicals or abrasive cleaners, which could damage the laminate or glass surfaces.
- Clean the glass shelves with appropriate glass-cleaning products to maintain visibility and avoid streaks.

24. Troubleshooting

• WHAT DO I DO IF THERE ARE MISSING PARTS FROM MY ORDER?

If there appears to be any part missing from your order, contact our friendly and helpful Customer Support Team within 7 days of receipt.

• FOR ALL OTHER ISSUES, PLEASE CONTACT OUR CUSTOMER SUPPORT TEAM.



A StepAlong by Monstershop

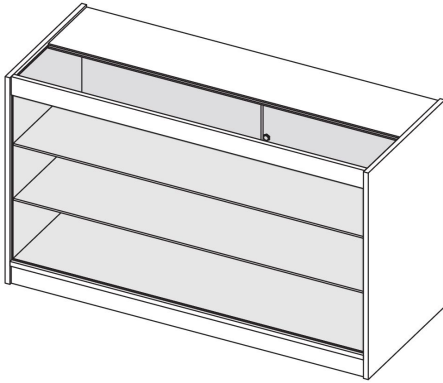

K900-1200 LED Shop Counter

204110/204111/204112/204119/204120/204121

Unit Overview

The K retail counter is a sleek, full glass-fronted display unit, designed to showcase products in an elegant and highly visible manner. Featuring three spacious shelves, it provides ample room for presenting a variety of items while keeping them secure behind lockable doors. LED lighting is included to beautifully illuminate the displayed products, ensuring they stand out in any retail environment. With its durable laminate frame and clear glass front, this counter is available in black, white, and maple, offering both security and a premium display solution for your store.

Dimensions

K900 Dimensions:

- **Product Height:** 0.9m
- **Product Depth:** 0.6m
- **Product Width:** 0.9m
- **Top Shelf Max Storage Height:** 24.1cm
- **Middle Shelf Max Storage Height:** 24.5cm
- **Bottom Shelf Max Storage Height:** 24.5cm
- **Keys Included:** 2
- **3 Colours:** Black, Maple, White
- **Net Weight:** 65.4kg



K1200 Dimensions:

- **Product Height:** 0.9m
- **Product Depth:** 0.6m
- **Product Width:** 1.2m
- **Top Shelf Max Storage Height:** 24.1cm
- **Middle Shelf Max Storage Height:** 24.5cm
- **Bottom Shelf Max Storage Height:** 24.5cm
- **Keys Included:** 2
- **3 Colours:** Black, Maple, White
- **Net Weight:** 84.5kg

Specifications

K900 Specifications:

- **Power (W):** 5.3W
- **Power Supply (Input Voltage):** 100~240V
- **Voltage:** 12V
- **Brightness (Lumen):** 221.1LM
- **Colour Temperature (K):** 6489K
- **Lifespan (Hours):** 30000H
- **Operating Temperature Range:** '-20 ~ 50

K1200 Specifications:

- **Power (W):** 7.2W
- **Power Supply (Input Voltage):** 100~240V
- **Voltage:** 12V
- **Brightness (Lumen):** 296.1LM
- **Colour Temperature (K):** 6432K
- **Lifespan (Hours):** 30000H
- **Operating Temperature Range:** '-20 ~ 50



Safety Advice

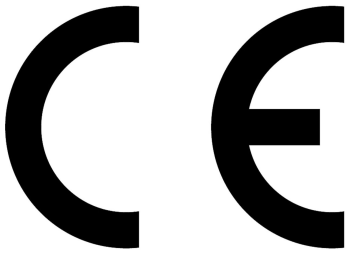









- Please read through the Safe Working Practice to ensure prevention of injury or damage to the device.
- Make sure the unit is positioned on a flat, stable surface to prevent wobbling or tipping.
- If placing the unit on uneven flooring, use appropriate levelling methods to secure the unit.
- Do not exceed the specified weight limits for the shelves and surfaces to avoid damage to the unit or risk of injury.
- Ensure products are evenly distributed across shelves to prevent tipping or overloading.
- Ensure that children do not climb or play on the unit to prevent accidents or injury.
- Regularly inspect for any wear, such as loose screws or weak joints, and tighten or repair as necessary.
- There may be debris and/or sawdust in the pre-drilled holes. Remove this before commencing with assembly. Use gloves to remove it.
- Be cautious when handling items on glass shelves. Do not overload the shelves beyond their stated capacity, as this could lead to cracking or shattering.





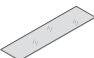
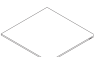



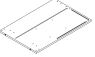

- Always ensure the unit is properly plugged into a suitable power outlet with the correct voltage as indicated in the specifications.
- Do not allow the LED light strip to come into contact with water or moisture to avoid electrical hazards.
- Regularly inspect the LED strip and power cables for wear or damage. If any damage is noticed, immediately disconnect the power supply and seek professional assistance for repairs.
- Never attempt to modify or alter the electrical components or wiring of the LED light system.
- Ensure the power supply is switched off before performing any maintenance, cleaning, or adjusting of the LED lights.
- We recommend turning off the LED lights at the close of each business day to ensure energy efficiency and prolong the lifespan of the lights.
- Ensure proper ventilation around the LED lights to avoid overheating, especially if the unit is in constant use.
- Avoid covering or obstructing the LED lights to prevent overheating, which could shorten their lifespan or cause damage.
- Do not install the unit near any heat sources, such as radiators, as excessive heat can affect the longevity of the LED strip.
- Keep power cables and exposed lighting out of reach of children and animals to avoid accidental damage or injury.

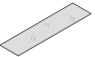
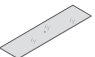

Parts

1 - Bottom Shelf 1 Piece(s)	
3 - Kick Plate 1 Piece(s)	
5 - Side Panel 1 Piece(s)	
7 - Glass Mounting Bar 1 Piece(s)	
9 - LED-Integrated Counter-top 1 Piece(s)	
11 - Top Glass Shelf 1 Piece(s)	
13 - Door 1 Piece(s)	
B - Cam Lock 10 Piece(s)	
D - Phillips Head Screw 10 Piece(s)	
F - LED Extension Cable 1 Piece(s)	
H - Glass Shelf Support 8 Piece(s)	

2 - Kick Plate with Cable Pass-Through 1 Piece(s)	
4 - Side Panel 1 Piece(s)	
6 - Front Glass Panel 1 Piece(s)	
8 - Countertop Glass 1 Piece(s)	
10 - Bottom Glass Shelf 1 Piece(s)	
12 - Door with Lock Slot 1 Piece(s)	
A - Connector Screw 10 Piece(s)	
C - Door Lock 1 Piece(s)	
E - Power Adapter 1 Piece(s)	
G - Slot Cover Strip 2 Piece(s)	



Steps (22)

1.

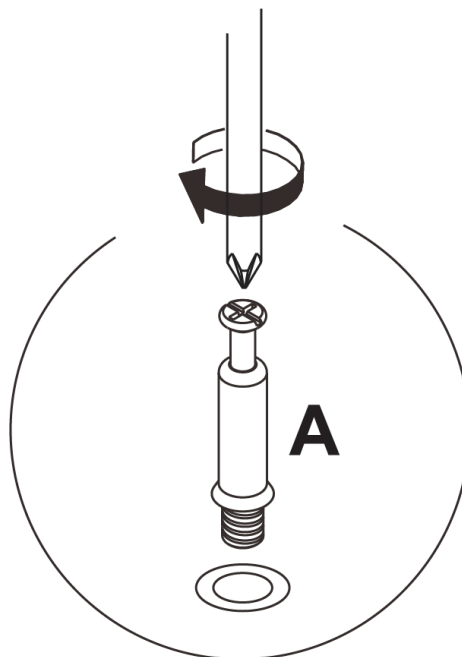
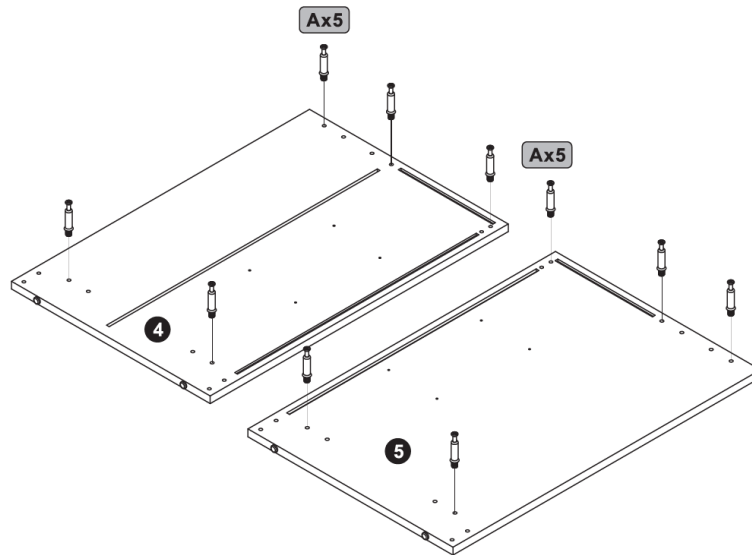

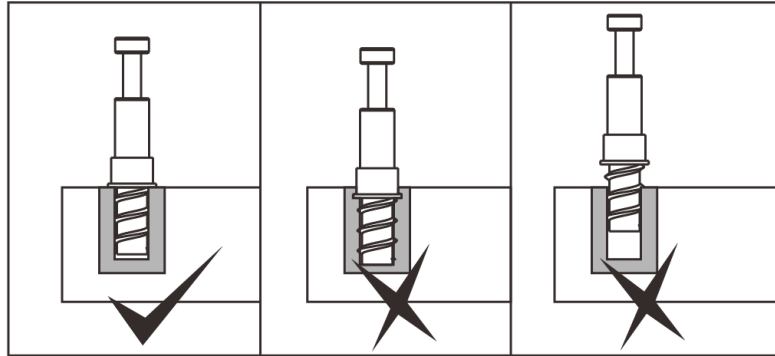

2.

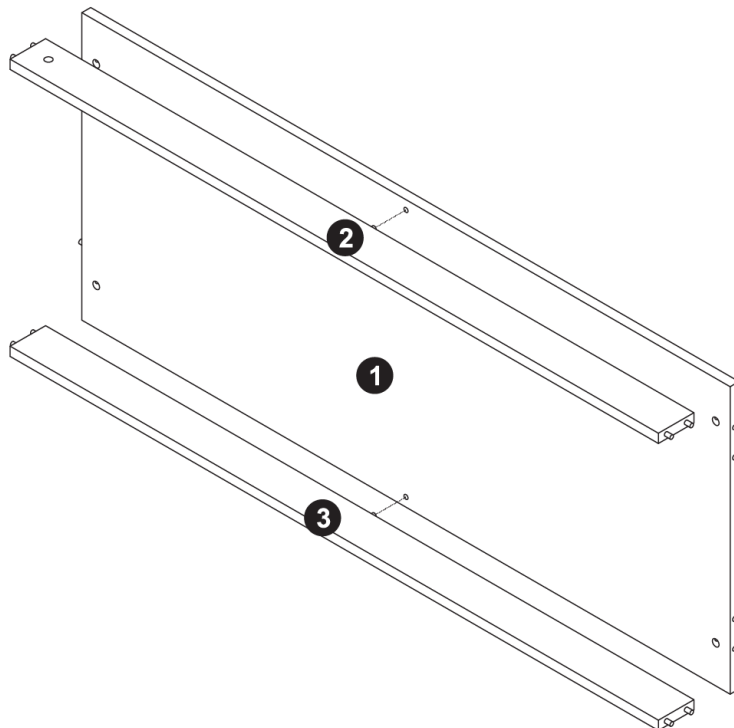

3.

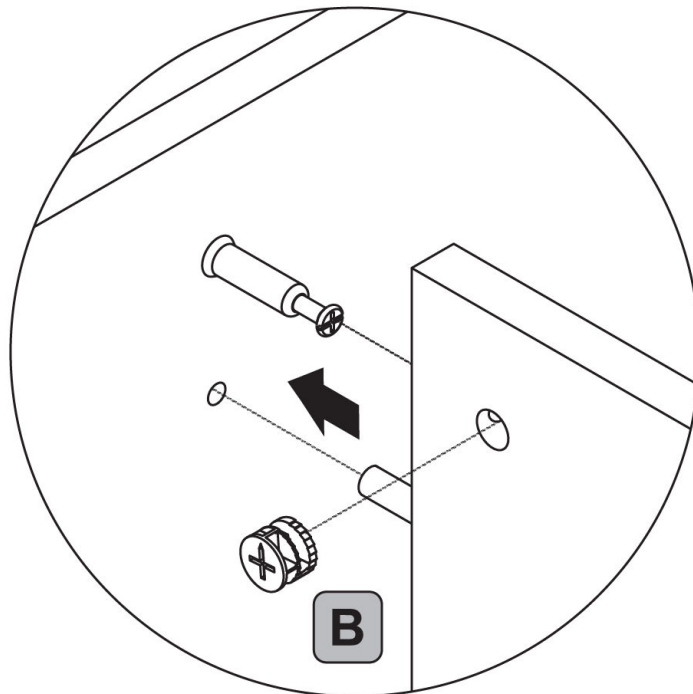
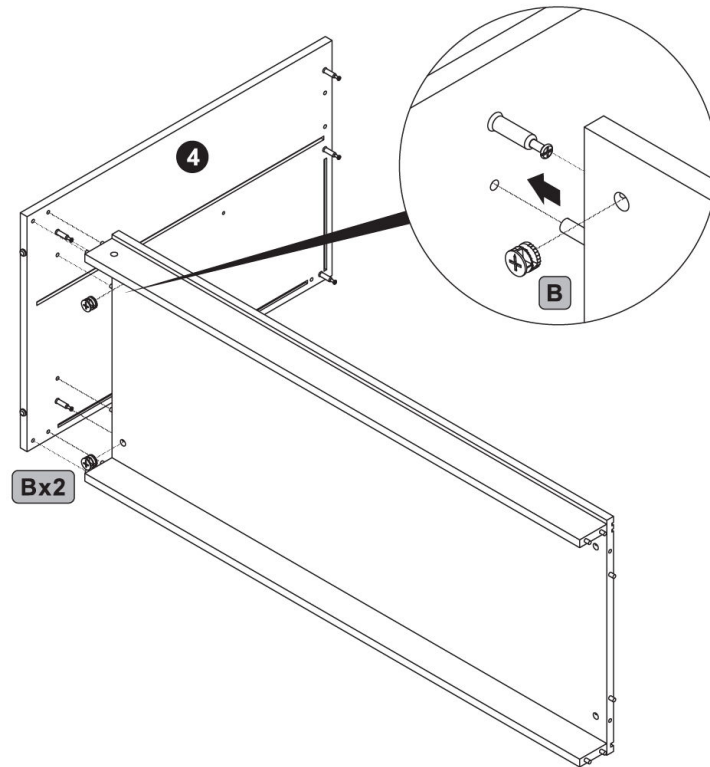

4.

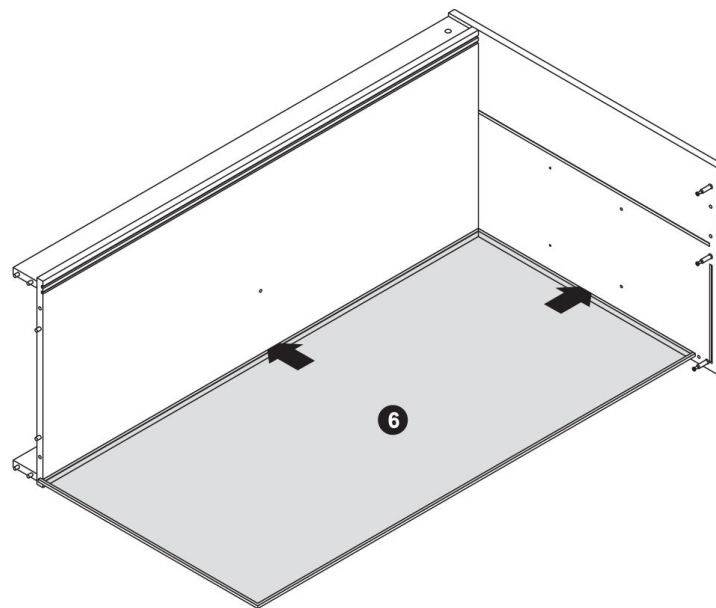

5.

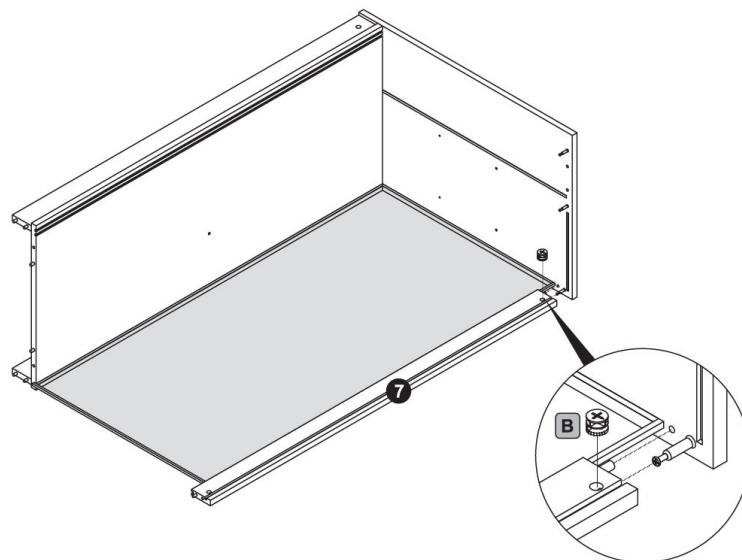

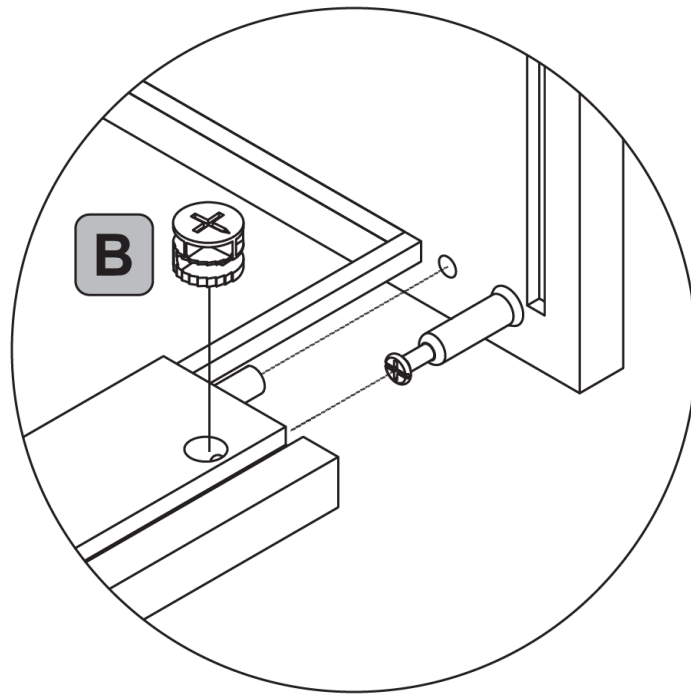

6.

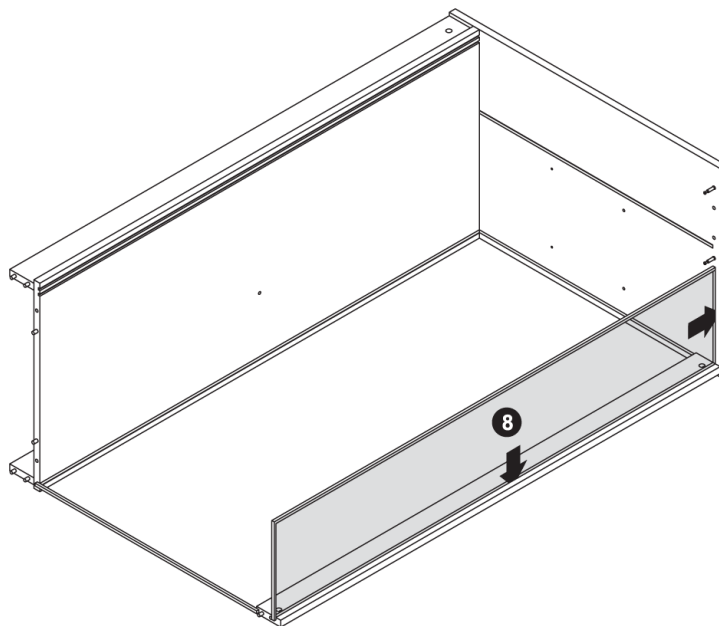

7.

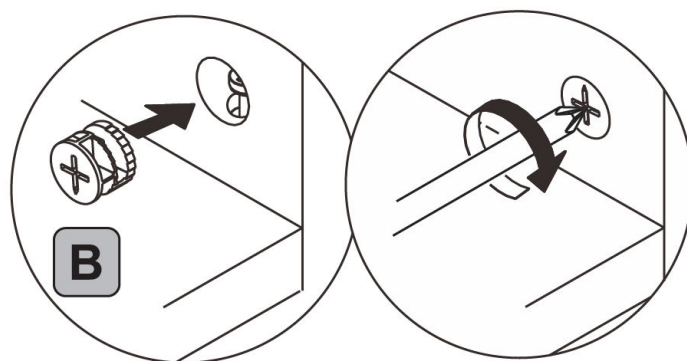
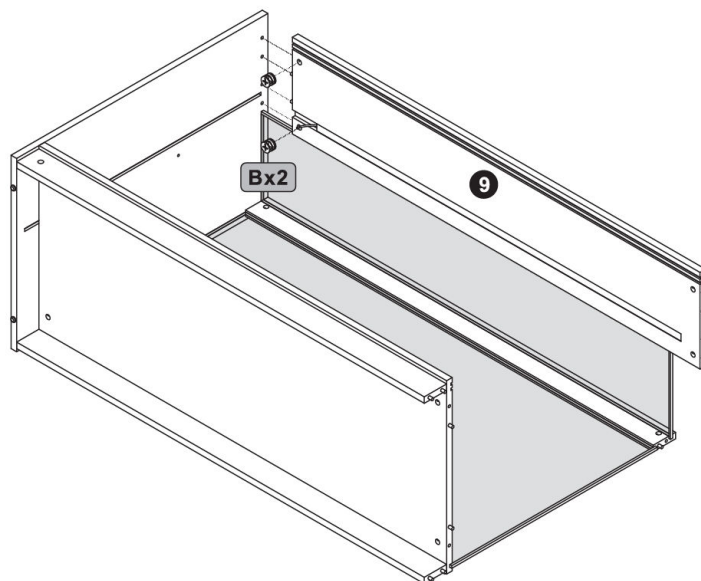

8.

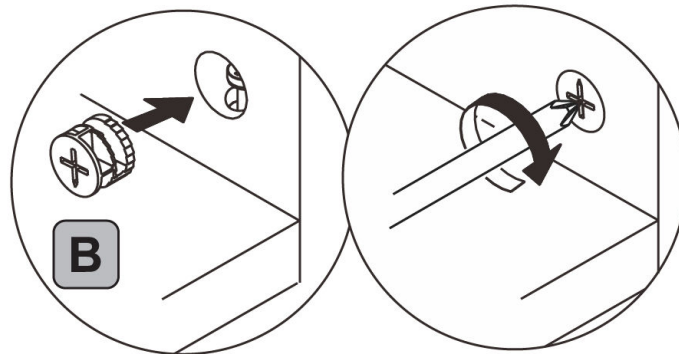
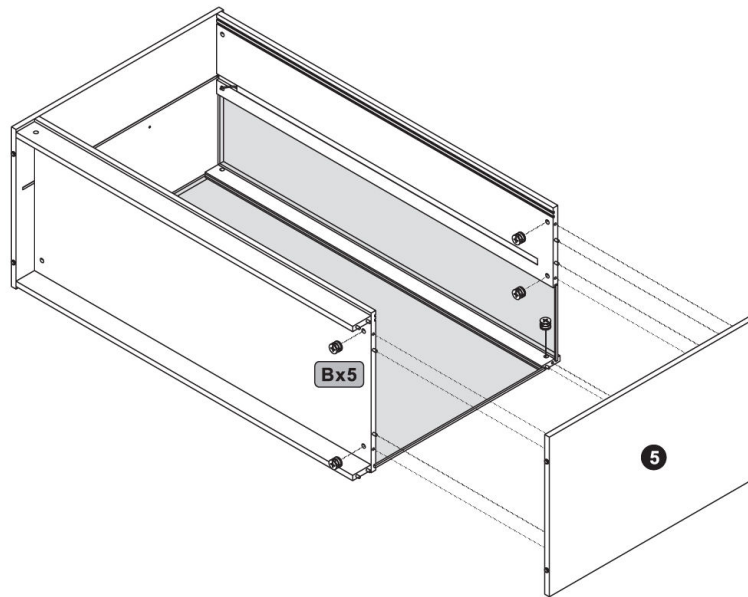

9.

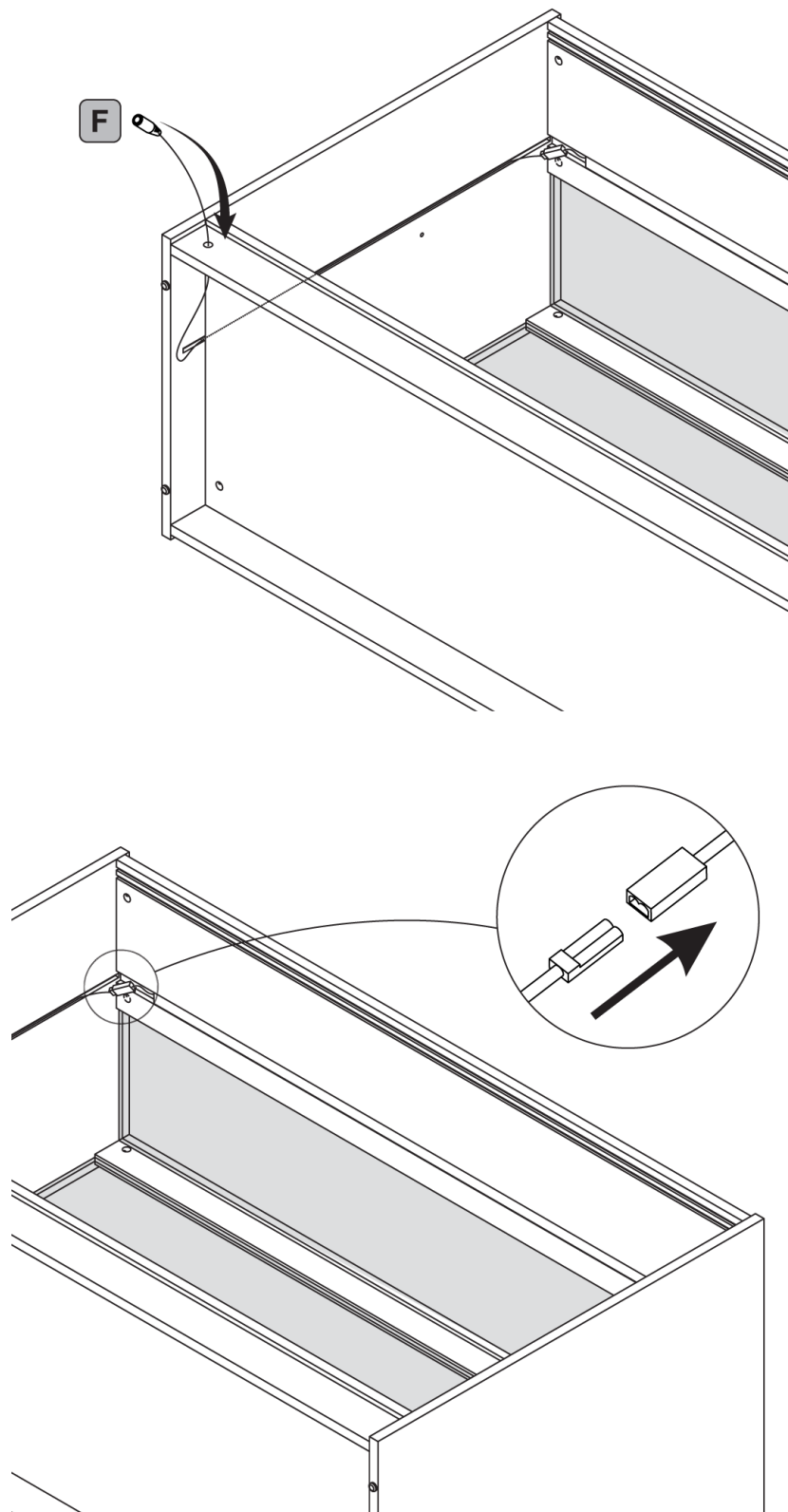

10.

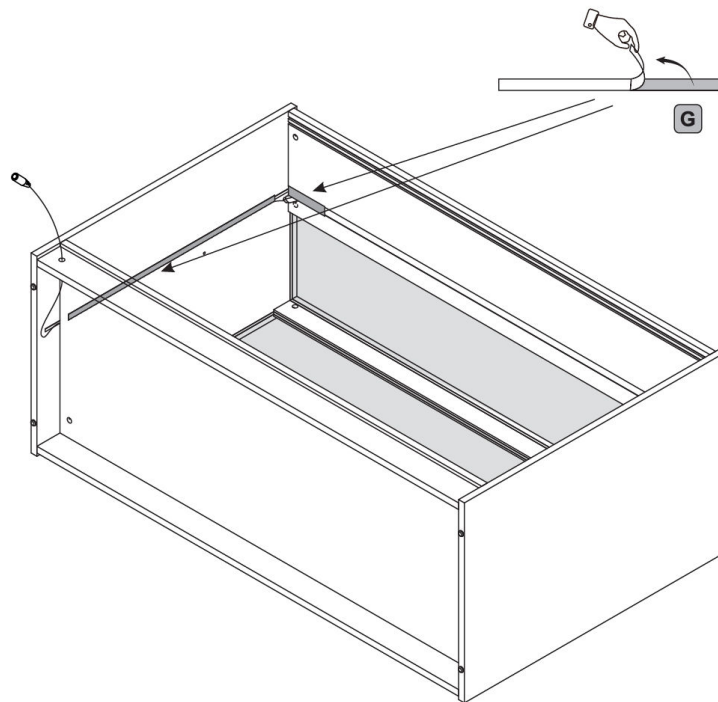

11.

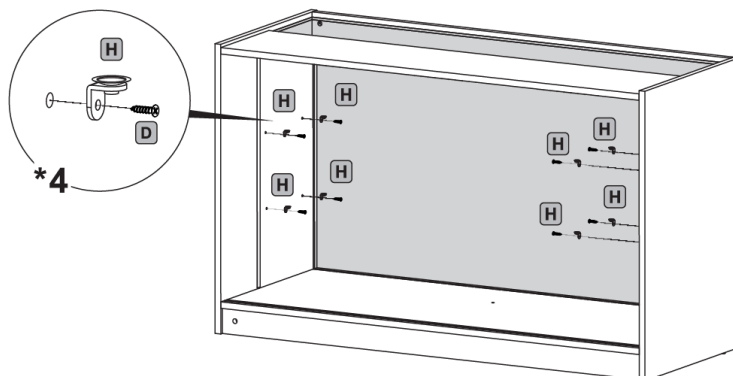

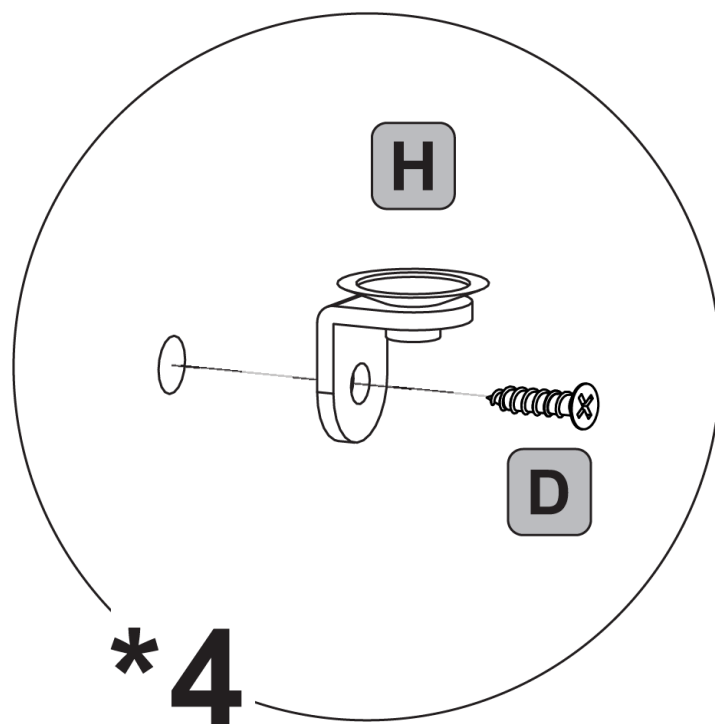

12.

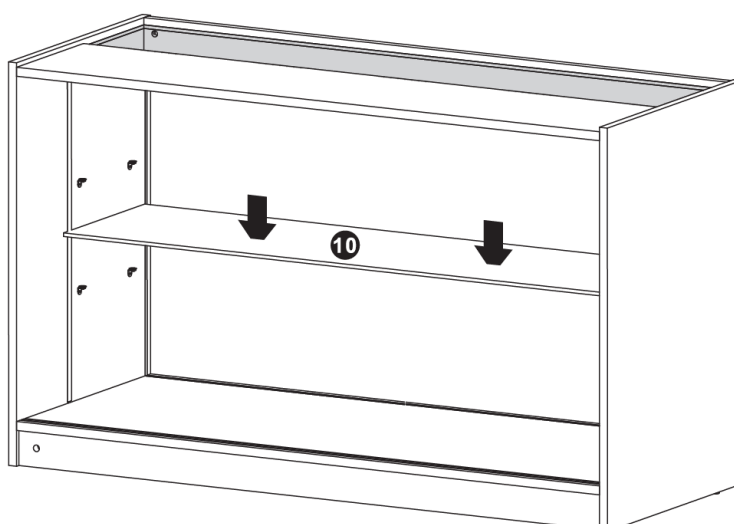

13.



14.

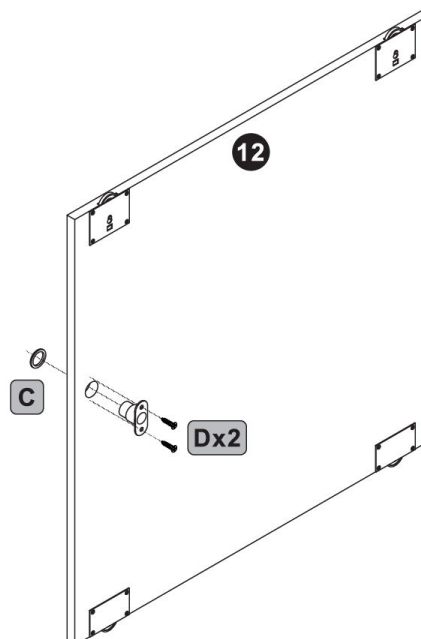

15.

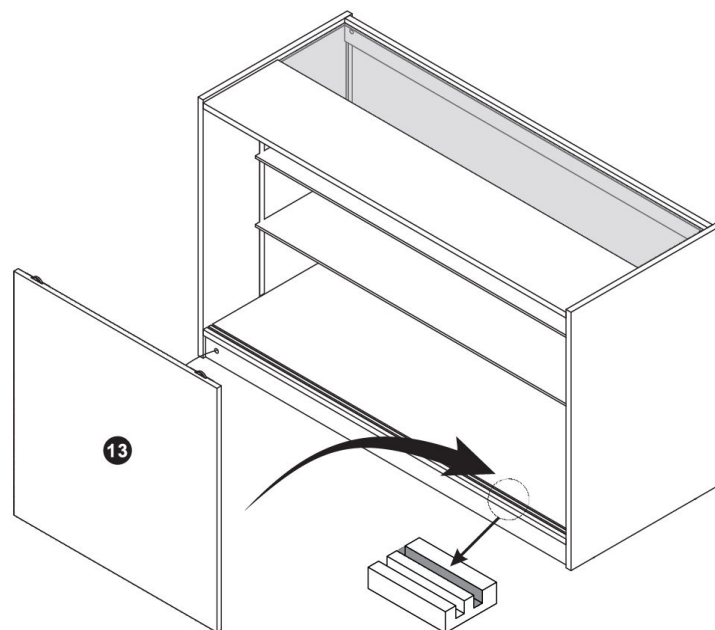

16.

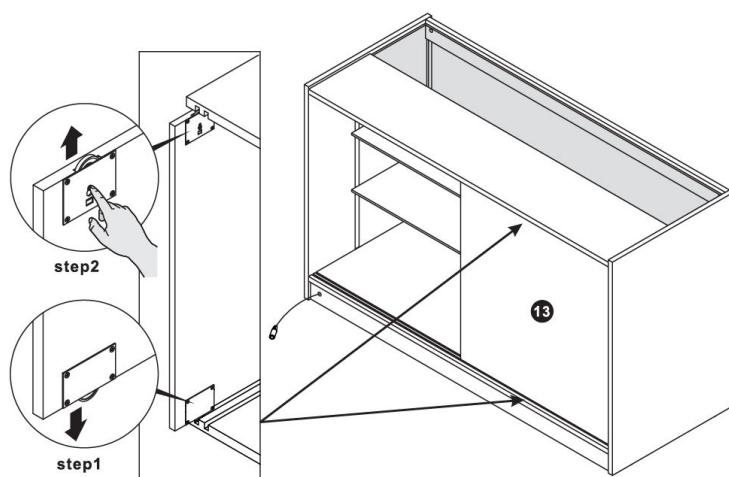

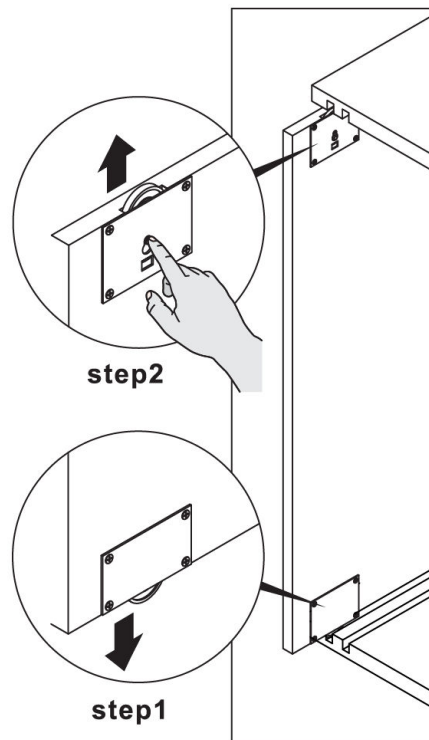

17.

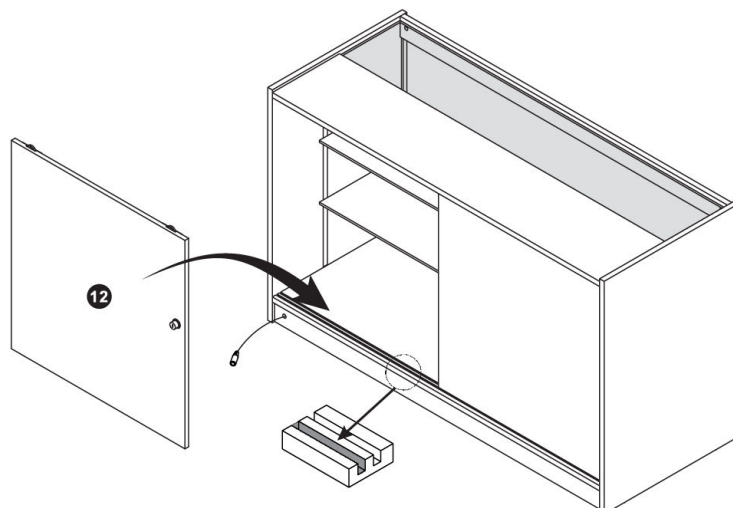

18.

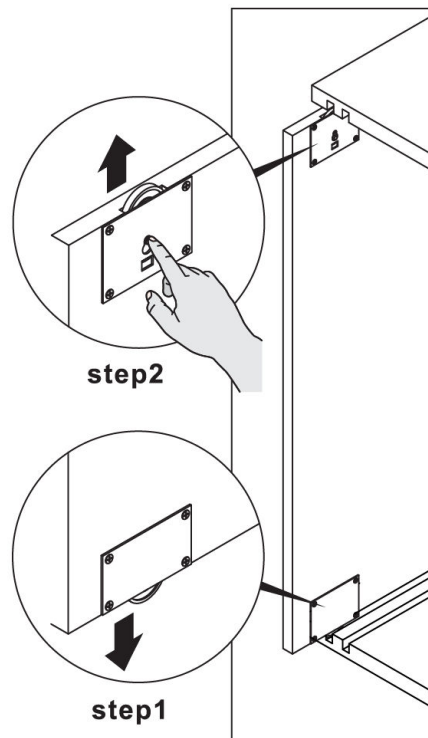
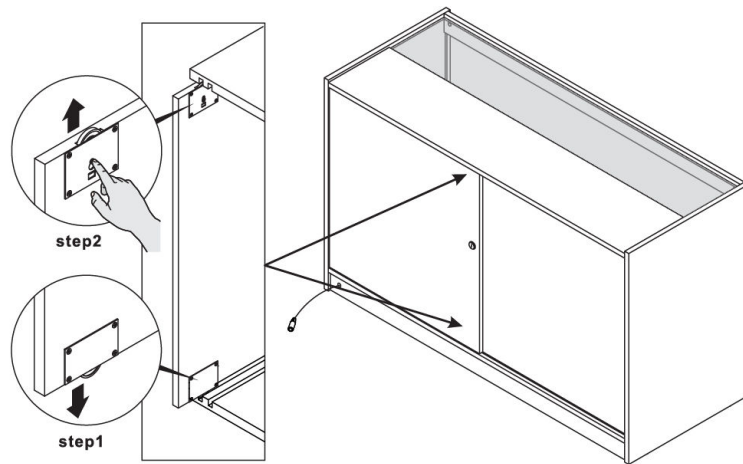

19.

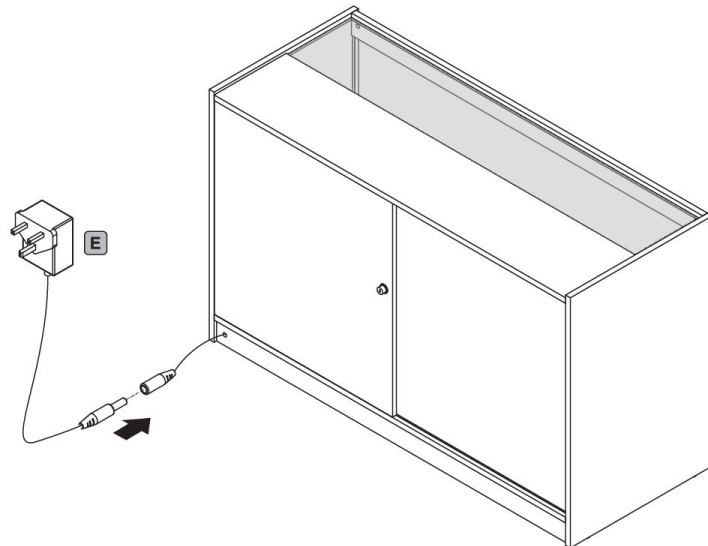

20.

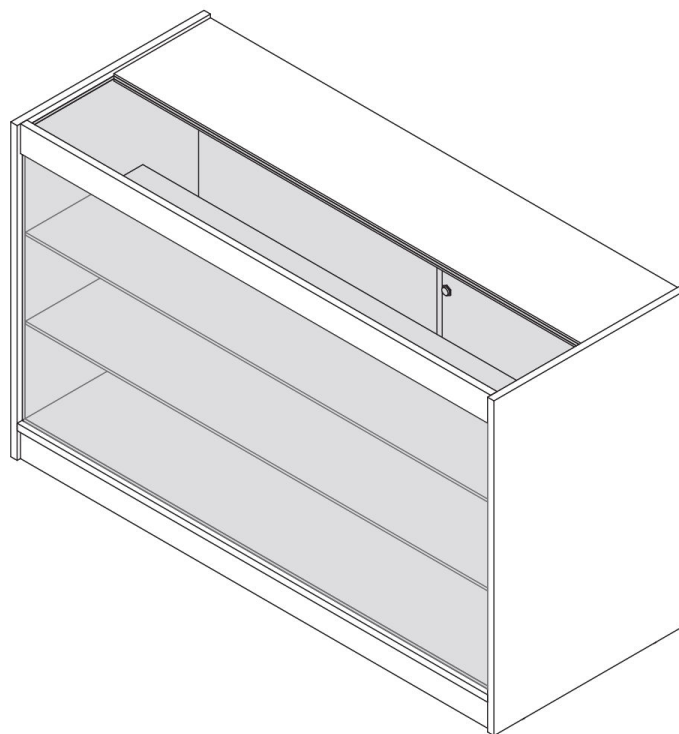

21. Maintenance

- Clean the unit with a soft, damp cloth. Avoid using harsh chemicals or abrasive cleaners, which could damage the laminate or glass surfaces.
- Clean the glass shelves with appropriate glass-cleaning products to maintain visibility and avoid streaks.

22. Troubleshooting

- **WHAT DO I DO IF THERE ARE MISSING PARTS FROM MY ORDER?**

If there appears to be any part missing from your order, contact our friendly and helpful Customer Support Team within 7 days of receipt.

- **FOR ALL OTHER ISSUES, PLEASE CONTACT OUR CUSTOMER SUPPORT TEAM.**

